

VICINITY MAP

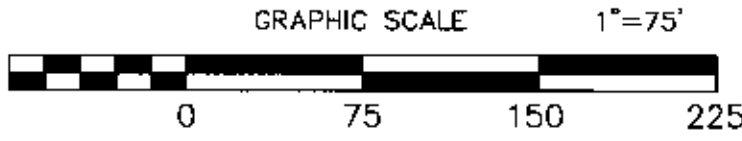

CERTIFICATE OF DRAINAGE DESIGN APPROVAL
I HEREBY CERTIFY THAT THE PROPOSED DRAINAGE DESIGN, AS SHOWN ON THIS DEVELOPMENT PLAN, IS ADEQUATE FOR PROPER DRAINAGE WITHOUT CAUSING ANY ADVERSE EFFECTS TO THE ADJOINING PROPERTIES.

DATE: _____ ENGINEER
DATE: _____ ENGINEER

HYDRAULIC STUDY/ANALYSIS CERTIFICATE
I hereby certify that appropriate measures have been identified and considered into the design to satisfy the requirement that no off-site or on-site property will suffer any related damage as a result of this development, and this design is in accordance with the required study.

Date: _____ Engineer: _____

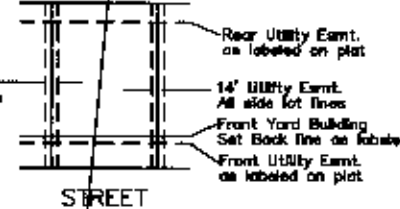

TYPICAL LOT EASEMENTS

CERTIFICATE OF APPROVAL BY UTILITY COMPANIES
I (WE) HEREBY CERTIFY THE UTILITY EASEMENTS ARE APPROVED AS SHOWN, WITH RESTRICTIONS LISTED HEREON

K.U. COMPANY	DATE	BELL SOUTH	DATE
SHELBY ENERGY	DATE	ATOMS ENERGY	DATE
WATER CO.	DATE	SEWER COMPANY	DATE
TELECOMMUNICATIONS	DATE	DEVELOPER	DATE

THE SPACES INDICATED BY DASHED LINES AND MARKED UTILITY EASEMENTS ARE HEREBY RESERVED FOR THE USE OF UTILITY COMPANIES LISTED ABOVE FOR UTILITY PURPOSES AND WATER AND GAS COMPANIES FOR UNDERGROUND PIPES AND BELL SOUTH TELEPHONE, ELECTRIC UTILITIES, AND TELECOMMUNICATIONS PURPOSES, WHICH INCLUDE:
1. THE RIGHT TO CONSTRUCT, MAINTAIN, OPERATE, REPLACE, OR REBUILD POLE LINES AND/OR UNDERGROUND CABLE SYSTEMS;
2. THE RIGHT TO CONSTRUCT, MAINTAIN, OPERATE, REPLACE, OR REBUILD UNDERGROUND PIPE LINES;
3. THE RIGHT TO INGRESS AND EGRESS OVER ALL LOTS TO AND FROM SAID EASEMENTS INDICATED;
4. THE RIGHT TO TRIM OR REMOVE ANY TREE, NECESSARY TO MAINTAIN PROPER SERVICE; AND
5. THE RIGHT TO KEEP SAID EASEMENTS FREE OF ANY STRUCTURES OR OBSTACLES THAT MAY CREATE A HAZARD TO THE SAID POLE LINES OR CABLES. IT IS UNDERSTOOD THAT A PART OF THIS RESERVATION THE OWNERS, THEIR HEIRS, OR ASSIGNS HEREBY AGREE THAT NO EXCAVATION WILL BE ATTEMPTED WITHIN 5 FEET OF ANY BURIED CABLES INSTALLED WITHIN THE EASEMENT HEREON DEFINED. PROPERTY OWNERS ARE TO USE AND ENJOY THE SAID LANDS INCLUDED IN THE EASEMENT STRIPS SHOWN HEREON BUT SUCH USE SHALL NOT INTERFERE WITH THE RIGHTS AND PRIVILEGES HEREIN RESERVED. HEREIN RESERVED.

CERTIFICATE OF APPROVAL FOR ELECTRIC SERVICE
I HEREBY CERTIFY THE THIS PLAT OF _____ MEADOW GLEN LIES WITHIN THE SERVICE AREA OF _____ KENTUCKY UTILITIES & SHELBY ENERGY AND SAID UTILITY HAS THE CAPACITY TO SUPPLY ADEQUATE ELECTRIC SERVICE TO SAID SUBDIVISION.

DATE: _____ AUTHORIZED REPRESENTATIVE

CERTIFICATE OF APPROVAL FOR GAS SERVICE
I HEREBY CERTIFY THE THIS PLAT OF _____ MEADOW GLEN LIES WITHIN THE SERVICE AREA OF _____ ATOMS ENERGY AND SAID UTILITY HAS THE CAPACITY TO SUPPLY ADEQUATE GAS SERVICE TO SAID SUBDIVISION.

DATE: _____ AUTHORIZED REPRESENTATIVE

CERTIFICATE OF STATE ROADWAY ENTRANCE
I HEREBY CERTIFY THAT AN ENTRANCE FROM THE PROPOSED DEVELOPMENT MAY BE GRANTED ONTO THE STATE ROUTE, AT THE LOCATION SHOWN HEREON SUBJECT TO MEETING ALL CRITERIA OF, AND OBTAINING A STATE ENCROACHMENT PERMIT FOR THE ENTRANCE. THERE SHALL BE NO ADDITIONAL DIRECT VEHICULAR ACCESS TO THE STATE ROUTE UNLESS SHOWN ON THE PLAN.

Date: _____ Authorized Representative

CERTIFICATION OF AVAILABILITY OF WATER SERVICES
I HEREBY CERTIFY THAT THE PROPOSED SUBDIVISION SHOWN HEREON LIES WITHIN THE SERVICE AREA OF _____ SHELBY COUNTY WATER & SEWER COMMISSION AND THAT SAID UTILITY HAS THE CAPACITY TO SUPPLY WATER TO THE PROPOSED SUBDIVISION, ASSUMING THAT THE WATER DISTRIBUTION SYSTEM IS INSTALLED WITHIN SAID SUBDIVISION ACCORDING TO THE UTILITIES SPECIFICATIONS. SUBJECT TO APPROVAL BY THE KENTUCKY DIVISION OF WATER.

DATE: _____ AUTHORIZED REPRESENTATIVE

CERTIFICATE OF OWNERSHIP
WE HEREBY CERTIFY THAT WE ARE THE OWNERS OF THE PROPERTY SHOWN HEREON AND THAT WE HEREBY ADOPTE THIS PLAN WITH OUR FREE CONSENT. THIS DIVISION DOES NOT VIOLATE ANY PRIVATE SUBDIVISION RESTRICTIONS.

DATE: _____ OWNER

CERTIFICATION OF THE AVAILABILITY OF SEWAGE DISPOSAL SERVICES
I HEREBY CERTIFY THAT THE SHELBY COUNTY WATER & SEWER COMMISSION SHALL SUPPLY MEADOW GLEN WITH SEWAGE DISPOSAL SERVICES AND THE SEWAGE DISPOSAL SYSTEM OF SAID SUBDIVISION MEETS THE REQUIREMENTS OF THIS AGENCY AND ALL OTHER REQUIREMENTS FOR THE PROPER DISPOSAL OF SEWAGE. SUBJECT TO APPROVAL BY THE KENTUCKY DIVISION OF WATER.

DATE: _____ AUTHORIZED REPRESENTATIVE

RECORDING CERTIFICATE
I HEREBY CERTIFY THAT THE PLAT OF _____ MEADOW GLEN HAS BEEN APPROVED BY THE TRIPLE S PLANNING COMMISSION.

DATE: _____ CHAIRMAN PLANNING COMMISSION

LAND SURVEYORS CERTIFICATE
I HEREBY CERTIFY THAT THE PLAT SHOWN HEREON DEPICTS A SURVEY MADE BY ME, OR UNDER MY DIRECT SUPERVISION, BY THE METHOD OF RANDOM TRAVERSE WITH SIDESHOTS. THE UNADJUSTED PRECISION RATIO OF THE TRAVERSE WAS 1:10000 or better and WAS NOT ADJUSTED. THE SURVEY SHOWN HEREON IS A CLASS "A" SURVEY AND THE ACCURACY AND PRECISION OF SAID SURVEY MEETS ALL THE SPECIFICATIONS OF THIS CLASS.

DATE: _____ PROFESSIONAL LAND SURVEYOR

ROADWAY CERTIFICATE
I HEREBY CERTIFY THAT THE ROAD CONSTRUCTION PLANS HAVE BEEN REVIEWED AND HEREBY APPROVED BY THE COUNTY ROAD SUPERVISOR OF SHELBY COUNTY.

DATE: _____ COUNTY ROAD OFFICIAL

CERTIFICATION OF THE APPROVAL OF WATER AND SEWERAGE SYSTEMS
I HEREBY CERTIFY THAT THE PUBLIC WATER SUPPLY AND THE PUBLIC SEWAGE DISPOSAL SYSTEMS INSTALLED, OR PROPOSED TO BE INSTALLED IN THE SUBDIVISION ENTITLED _____ MEADOW GLEN FULLY MEETS THE REQUIREMENTS OF THE HEALTH DEPARTMENT, AND HEREBY IS APPROVED AS SHOWN.

DATE: _____ COUNTY HEALTH OFFICER

FIRE DEPARTMENT CERTIFICATE
I HEREBY CERTIFY THAT THE DIVISION SHOWN HEREON LIES WITHIN THE FIRE SERVICE AREA OF THIS FIRE DISTRICT, AND MEETS OR EXCEEDS ALL CURRENT STANDARDS FOR FIRE PROTECTION AND WILL BE SERVED BY SAME.

DATE: _____ FIRE DISTRICT REPRESENTATIVE

CERTIFICATION OF DRAINAGE CONSTRUCTION
UPON CONSTRUCTION OF BONDED DRAINAGE IMPROVEMENTS SHOWN ON THE FACE OF PLAT AND OR CONSTRUCTION PLANS THE DEVELOPER/OWNER SHALL BE REQUIRED TO PROVIDE A LETTER OF CERTIFICATION TO TRIPLE S PLANNING AND ZONING COMMISSION FROM A PROFESSIONAL ENGINEER LICENSED IN THE COMMONWEALTH OF KENTUCKY THAT THE DRAINAGE IMPROVEMENTS SHOWN ON THE PLANS HAVE BEEN CONSTRUCTED SO AS TO SATISFY THE INTENT OF THE ORIGINAL DESIGN. ANY SIGNIFICANT CHANGES FROM THE ORIGINAL DESIGN SHALL BE NOTED IN THE CERTIFICATION, AND THE CERTIFYING ENGINEER SHALL COMMENT AS TO THE EFFECT THESE CHANGES HAD ON THE ORIGINAL DESIGN.

Date: _____ Authorized Representative

Parcel A must be conveyed to an adjoining owner as shown on face of plat.

Parcel "A" 0.02AC

OWNERS: Jagoe Land Corporation
PO Box 23019
Owensboro, KY 42304
Date of Plat - December 25, 2003
Source of Title - Deed Book 443 Page 523
Total Area Section 1 = 14.83 Acres
Total Lots Section 1 = 42
Total Lots Section 16 = 116

LEGISLATIVE SURVEYS
PROFESSIONAL LAND SURVEYS AND DESIGN
505 MAIN STREET, SHELBYVILLE, KY 40065-0502
TEL: 502-639-1116

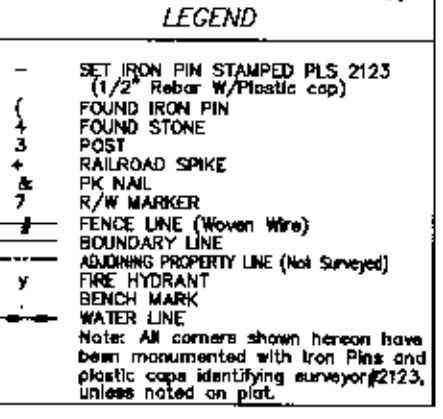

General Notes:
1. No on street parking allowed, all lots must have driveways with a minimum width of 18' for 2 car parking.
2. Lot 1 will have no access to Mt. Eden Rd.

FINAL PLAT
MEADOW GLEN SECTION I
SHELBY COUNTY, KENTUCKY