

# NORTHWEST NEIGHBORHOOD PIMA COUNTY NEIGHBORHOOD REINVESTMENT GRANT PROJECT DESIGN

## GENERAL PROJECT DESCRIPTION

THIS PROJECT INCLUDES THE CONSTRUCTION OF CHICANES ALONG ELM STREET AND 5TH AVENUE, A GREENWAY ALONG 5TH AVENUE AND A PEDESTRIAN CORRIDOR THAT EXTENDS FROM LINDEN STREET TO WAVERLY STREET AND THENCE TO AN EXISTING PEDESTRIAN PATH ALONG THE SOUTHERN BOUNDARY OF MANSFIELD PARK.

### LEGEND

- R/W RIGHT-OF-WAY  
P PROPERTY LINE  
S SANITARY SEWER MANHOLE  
F FIRE HYDRANT  
G GAS METER  
C GUY WIRE  
PP POWER POLE  
PPR POWER POLE WITH RISER  
S SIGN  
SL STREET LIGHT  
SLP STREET LIGHT PULL BOX  
T TELEPHONE PEDESTAL  
W WATER METER  
V WATER VALVE  
W WATER LINE  
S SEWER LINE  
G GAS LINE  
M MAILBOX  
G EXIST. GAS LINE  
OH EXIST. OVERHEAD ELECTRIC  
W EXIST. WATER



SCALE: 1" = 100'

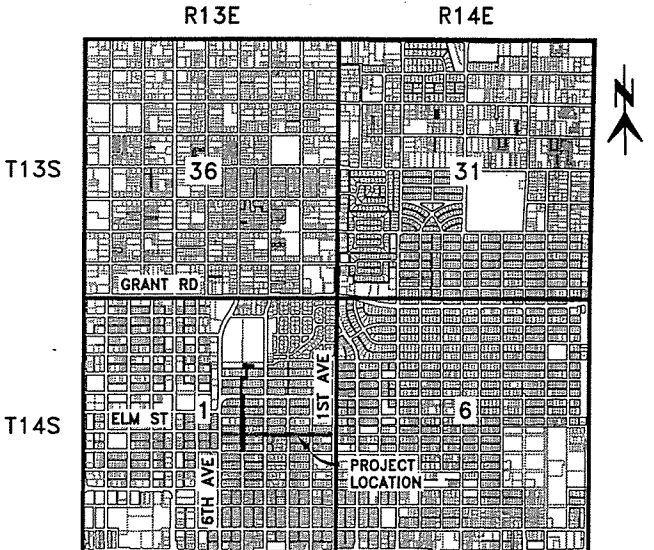
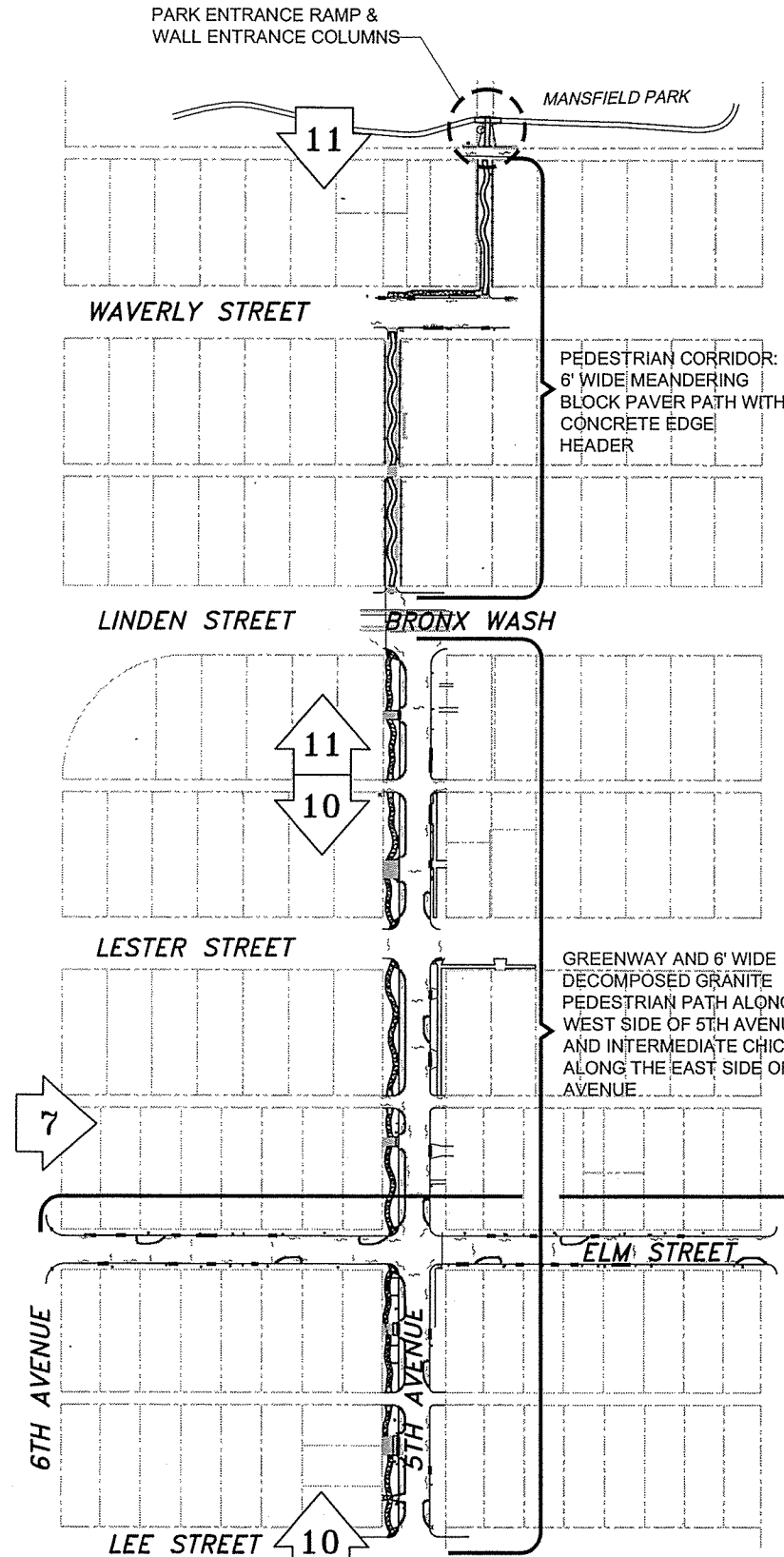

### LOCATION MAP

SECTION 01, T14S, R13E  
GILA AND SALT RIVER MERIDIAN  
PIMA COUNTY, ARIZONA  
SCALE: 3" = 1 MILE

### SHEET INDEX

SHEET 1	COVER SHEET
SHEET 2-3	GENERAL NOTES/TYPICAL SECTIONS & CROSS SECTIONS
SHEET 4-6	DETAIL SHEETS
SHEET 7-11	PLAN SHEETS

PCRWRD UTILITY NO.: UPC-2010-008

DEPARTMENT OF TRANSPORTATION/ENGINEERING DIVISION

NORTHWEST NEIGHBORHOOD PIMA COUNTY  
NEIGHBORHOOD REINVESTMENT  
GRANT PROJECT



Approvals	Signature	Date	Approved	20	1
ENGINEERING ADMINISTRATOR					OF
TRAFFIC PLANNING & DESIGN ADMINISTRATOR					11
LANDSCAPE ARCHITECT					
REF.					
SCALE: N/A					
PLAN NO.					

**Kimley-Horn and Associates, Inc.**  
© 2010 KIMLEY-HORN AND ASSOCIATES, INC.  
2210 East Fort Lowell Road, Suite 200  
Tucson, Arizona 85719 (520) 615-9191

NO.	DATE	REVISION	BY	CHKD.	APPR.
-----	------	----------	----	-------	-------

K:\TIC\_Roadway\080334005\_Northwest\_Neighborhood\_Grant\CD\134005001.dwg Ad 15, 2010 rld.wat  
XREFS: 134005001 134005001 134005001 134005001 134005001 134005001 134005001 134005001 134005001 134005001



## GENERAL CONSTRUCTION NOTES:

- ALL CONSTRUCTION, MATERIALS, WORKMANSHIP, AND TEST METHODS SHALL BE IN CONFORMANCE WITH PIMA COUNTY/CITY OF TUCSON STANDARD SPECIFICATIONS FOR PUBLIC IMPROVEMENTS (PC/COT) 2003 EDITION AND ANY AMENDMENTS THERETO.
- CONTRACTOR SHALL COMPLY WITH ALL APPLICABLE OCCUPATIONAL SAFETY AND HEALTH ADMINISTRATION REGULATIONS.
- CONTRACTOR SHALL OBTAIN ALL PERMITS REQUIRED BY GOVERNMENTAL AGENCIES.
- A SEALED AND APPROVED SET OF THESE PLANS SHALL BE KEPT IN AN EASILY ACCESSIBLE LOCATION ON THE JOB SITE AT ALL TIMES DURING CONSTRUCTION.
- UPON COMMENCEMENT OF WORK, TRAFFIC CONTROL DEVICES SHALL BE POSTED AND MAINTAINED BY THE CONTRACTOR UNTIL SUCH TIME AS THE WORK IS COMPLETED. ALL WARNING SIGNS, BARRICADES AND OTHER TRAFFIC CONTROL DEVICES SHALL BE IN ACCORDANCE WITH THE MANUAL OF UNIFORM TRAFFIC CONTROL DEVICES 2009 EDITION (MUTCD 2009).
- UTILITY LOCATIONS SHOWN ON THESE PLANS WERE COMPILED BASED ON PROJECT SURVEY AND MAPPING RECEIVED FROM UTILITY PROVIDERS. UTILITY LOCATIONS ARE NOT INTENDED TO BE EXACT OR COMPLETE. PRIOR TO CONSTRUCTION, THE CONTRACTOR SHALL VERIFY THE LOCATION OF ALL UTILITIES WITH THE APPROPRIATE ORGANIZATIONS. CONTACT "BLUE STAKE" AT 1-800-782-5348 TWO FULL WORKING DAYS PRIOR TO BEGINNING CONSTRUCTION. THE CONTRACTOR SHALL COORDINATE FIELD VERIFICATION OF WATER LINES WITH THE WATER DEPARTMENT CONSTRUCTION SECTION. POTHOLING IS REQUIRED AT ALL GAS AND WATER FACILITIES NEAR PROPOSED IMPROVEMENTS. THE CONTRACTOR SHALL TAKE ALL NECESSARY PRECAUTIONS IN ORDER TO AVOID DISRUPTION OF SERVICE.
- ALL WATER METERS, METER BOXES, REQUIRING REPLACEMENT OR REMOVAL SHALL BE RE-INSTALLED PER DETAIL NO. W-309, 310 & 316.
- THE CONTRACTOR SHALL CONTACT THE TUCSON WATER CONSTRUCTION SECTION REPRESENTATIVE: JB CELEY, 791-4665 OR MANNY MUNGIA, 850-5608, 48 HOURS IN ADVANCE TO COORDINATE ANY VALVE CLOSURES OR SERVICE OUTAGES REQUIRED IN THE METER AND METER BOX RE-INSTALLATION.
- THE CONTRACTOR SHALL BE RESPONSIBLE FOR ADJUSTING ALL NEW AND EXISTING WATER VALVE BOXES TO THE FINISHED GRADE PER DETAIL W-300.
- IN NO CASE SHALL NEW SERVICE LINES BE INSTALLED LESS THAN THREE (3.0') DEEP FROM THE FINISHED GRADE TO THE TOP OF THE NEW SERVICE LINE.
- THE CONTRACTOR SHALL BE RESPONSIBLE FOR ALL WATER METERS AND WATER BOXES IN THE CONSTRUCTION AREA. THIS WILL INCLUDE: REMOVAL AND INSTALLATION, PROTECTION OF METERS AND ACCESS TO METERS.
- SUBGRADE PREPARATION IN AREAS WHERE DG PATHWAY IS TO BE INSTALLED SHALL BE PER PC/COT SPECIFICATION SECTION 205 COMPACTED TO 95% DENSITY.
- COT/PC STANDARD DETAIL WMM 106 APPLIES TO ANY PROJECT THAT AFFECTS A LIVE SANITARY SEWER.
- THE CONTRACTOR SHALL IMPLEMENT GOOD HOUSEKEEPING PRACTICES TO PREVENT STORMWATER POLLUTION ON-SITE DURING THE COURSE OF CONSTRUCTION. GOOD HOUSEKEEPING PRACTICES INCLUDE, BUT ARE NOT LIMITED TO: STREET SWEEPING, PERIMETER STOCKPILE CONTROLS, SOLID WASTE MANAGEMENT, EQUIPMENT MAINTENANCE PROCEDURES, CONCRETE WASHOUTS, SPILL PREVENTION AND RESPONSE, AND STORM DRAIN INLET PROTECTION.
- IMMEDIATELY REPORT ANY RELEASE OF SEWAGE, AND/OR ANY SANITARY SEWAGE CONVEYANCE SYSTEM TO EITHER PCWRD FIELD ENGINEERING (740-2651) OR PCWRD CONVEYANCE DIVISION (443-6500) ON WEEKENDS, HOLIDAYS OR BETWEEN 5:00 PM AND 8:00 AM, IMMEDIATELY CALL PIMA COUNTY SHERIFF'S COMMUNICATION CENTER AT 295-4595 AND REQUEST A PCWRD REPRESENTATIVE TO BE DISPATCHED TO THE SITE. TAKE IMMEDIATE ACTION TO PREVENT OR CONTAIN THE SANITARY SEWAGE OVERFLOW (SSO) FROM THE SEWER SYSTEM. THE CONTRACTOR SHALL BE RESPONSIBLE FOR ALL COSTS TO REPAIR THE SYSTEM, FOR ALL EXPENSES TO MITIGATE THE RELEASE AND TO DISINFECT THE RELEASE AREAS, AND OR ANY REGULATORY PENALTIES LEVIED ON PCWRD BECAUSE THE SSO ENTERED A NATURAL OR CONSTRUCTED STORM WATER DRAINAGE SYSTEM. THE CONTRACTOR SHALL REPAIR ALL DAMAGE AS DIRECTED AND APPROVED BY PCWRD.
- HOUSE CONNECTION SEWERS (HCS), (BCS) AND PRIVATE SEWERS ARE NOT PART OF THE PUBLIC SANITARY SEWER CONVEYANCE SYSTEM. HCS CONSTRUCTED PRIOR TO JANUARY 2006 ARE NOT REQUIRED TO BE BLUE STAKED. ANY HCS ENCOUNTERED DURING CONSTRUCTION SHALL BE PROTECTED, REPAIRED, OR REROUTED, AS THE SITUATION DICTATES (COT/PC SD WMM404), AT NO EXPENSE TO THE PROPERTY OWNER OR THE PIMA COUNTY REGIONAL WASTEWATER RECLAMATION DEPARTMENT.
- CONTRACTOR SHALL MAINTAIN ACCESS TO ALL SANITARY SEWER MANHOLE STRUCTURES, AT ALL TIMES.
- SOUTHWEST GAS (SWG) REQUIRES THAT ALL TREE PLACEMENTS HAVE A MINIMUM OF 8 FOOT CLEARANCE FROM THE TREE CENTER LINE TO EXISTING GAS FACILITIES DUE TO ROOT COMPLICATIONS. SWG WILL ALLOW SHRUBS AND BUSHES TO BE PLANTED WITHIN 8 FEET OF EXISTING GAS FACILITIES. SWG ALSO REQUIRES A MINIMUM OF ONE (1) FOOT SEPARATION FROM DISTRIBUTION FACILITIES AND ANY PROPOSED STRUCTURES. THE CONTRACTOR SHALL BE RESPONSIBLE FOR MEETING THESE REQUIREMENTS AND GUIDELINES.
- CONTRACTOR MAY ADJUST THE STANDARD CHICANE DESIGN TO FIT FIELD CONDITIONS. SPECIAL ATTENTION IS GIVEN TO CHICANES NEAR GAS FACILITIES THAT REQUIRE ONE FOOT OFFSET TO ALL NEW STRUCTURES.
- CONTRACTOR SHALL NOTIFY THE POST OFFICE 48 HOURS PRIOR TO COMMENCING CONSTRUCTION. THE CONTRACTOR SHALL NOTIFY THE POST OFFICE 1 WEEK PRIOR TO RELOCATING A MAILBOX.
- ALL DIMENSIONS, DETAILS AND CALLOUTS IN THIS PLAN ARE APPROXIMATE. IT IS THE RESPONSIBILITY OF THE CONTRACTOR TO FIELD VERIFY PROPOSED WORK, AND ALERT THE ENGINEER OF ANY DISCREPANCIES FOUND.
- THE CONTRACTOR SHALL BE RESPONSIBLE FOR THE CARE AND MAINTENANCE OF EXISTING IMPROVEMENTS AND VEGETATION IN THE WORK AREA. PAVEMENT, CURBS, ADA ACCESS RAMPS, ALL PATHS AND ANY OTHER OBSTRUCTIONS DAMAGED DURING CONSTRUCTION ARE TO BE REPLACED BY THE CONTRACTOR. ANY UNDERGROUND PIPES, IRRIGATION LINES, IRRIGATION CONTROLS, DRAINS, STRUCTURES, OR OBSTRUCTIONS NOT SHOWN ON THESE PLANS SHALL BE MOVED, ALTERED, OR REPAIRED BY THE CONTRACTOR WHEN ENCOUNTERED, AS DIRECTED BY THE ENGINEER, AND SHALL BE CONSIDERED PART OF THIS PROJECT.
- ALL DESIGN STANDARDS, MATERIALS AND WORKMANSHIP FOR PUBLIC SANITARY SEWERS ARE TO BE IN ACCORDANCE WITH THE LATEST EDITION OF THE PIMA COUNTY REGIONAL WASTEWATER RECLAMATION DEPARTMENT'S (PCWRD) MANUAL OF ENGINEERING STANDARDS AND PROCEDURES, AND THE PIMA COUNTY/CITY OF TUCSON STANDARD DETAILS AND SPECIFICATIONS FOR PUBLIC IMPROVEMENTS. SAID MANUALS ARE ON FILE AT THE PIMA COUNTY REGIONAL WASTEWATER RECLAMATION DEPARTMENT OFFICES AT 201 N. STONE AVENUE, 8TH FLOOR.
- SEWER CONSTRUCTION SHALL NOT COMMENCE UNTIL: (A) CONTRACTOR HAS OBTAINED A PUBLIC SEWER CONSTRUCTION PERMIT FROM PIMA COUNTY REGIONAL WASTEWATER RECLAMATION (740-6369). (B) A PRE-CONSTRUCTION MEETING WITH THE ASSIGNED PIMA COUNTY PROJECT INSPECTOR IS SCHEDULED; AT LEAST THREE (3) FULL WORKING DAYS PRIOR TO THE START OF SEWER CONSTRUCTION. FLOW MANAGEMENT PLANS SHALL BE SUBMITTED TO FIELD ENGINEERING, THIRTY DAYS (30) PRIOR TO THE PRE-CONSTRUCTION MEETING.
- STOCKPILES MUST REMAIN OFF OF STREETS AND OUT OF WASHES.

- IT IS THE CONTRACTOR'S RESPONSIBILITY TO ADJUST OR RECONSTRUCT ALL SANITARY SEWER MANHOLE STRUCTURES TO FINISHED GRADE. ALL RING AND COVER ADJUSTMENTS ARE TO BE IN ACCORDANCE WITH THE CITY OF TUCSON/PIMA COUNTY STANDARD DETAILS FOR PUBLIC IMPROVEMENTS WMM 304, WMM 305 OR WMM 306 (AS APPLICABLE) AND WMM 307. WHILE ADJUSTING THE MANHOLE TO FINISHED GRADE, IT IS THE CONTRACTOR'S RESPONSIBILITY TO ENSURE THAT RINGS AND COVERS ARE CLEANED OF ANY AND ALL ATTACHED MATERIALS (ASPHALT, CONCRETE, ETC.), AND ENSURE THAT ANY VENT HOLES ARE OPEN AND CLEAR OF OBSTRUCTIONS. IF THE FRAMES AND COVERS ARE DAMAGED OR CANNOT BE COMPLETELY CLEANED, THEN A NEW FRAME AND COVER IS TO BE PUT INTO PLACE, AND COST ASSOCIATED WITH THESE ACTIONS ARE THE RESPONSIBILITY OF THE CONTRACTOR. REFER TO DETAILS WMM 213.0-214.3 FOR REQUIREMENTS FOR RINGS AND COVERS.
- THE COUNTY SHALL NOT BE HELD LIABLE OR RESPONSIBLE FOR ANY ERRORS AND OR OMISSIONS ON THESE PLANS. ITEMS NOT MEETING PIMA COUNTY STANDARDS SHALL BE REPAIRED OR REPLACED AT NO COST TO THE COUNTY.
- SWPPP MEASURES SHALL BE INSTALLED SO AS TO PREVENT ALL STORM WATER, CONSTRUCTION WATER, FUELS, CHEMICALS, OR LIQUIDS TO BE DIRECTED INTO OR ONTO ANY SANITARY SEWER FACILITIES. PROTECTION OF SANITARY SEWER FACILITIES SHALL BE A PART OF THE APPROVED CONSTRUCTION SWPPP AND BEST MANAGEMENT PRACTICES. PROTECTION DEVICES SHALL BE INSTALLED AND MAINTAINED AROUND ALL POTENTIALLY AFFECTED SANITARY SEWER FACILITIES WITHIN THE PROJECT LIMITS. ADDITIONAL MEASURES SHALL INCLUDE BUT NOT BE LIMITED TO THE USE OF RAIN STOPPERS AND WATERPROOF MANHOLE COVERS AS DEEMED NECESSARY BY THE PIMA COUNTY REGIONAL WASTEWATER RECLAMATION DEPARTMENT.

## LANDSCAPE NOTE:

LANDSCAPING ITEMS, QUANTITIES, AND CONSTRUCTION PROCEDURES ARE TO BE COORDINATED THROUGH THE CITY OF TUCSON LANDSCAPE ARCHITECT GARY WITTWER (520-791-5100). QUANTITIES AND PLANT TYPES WILL BE IDENTIFIED BY THE CITY OF TUCSON. THIS TYPICAL SECTION SHOWS THE GENERAL LOCATION OF PLANTING(S), A PLANT MOUND, AND THE PLACEMENT OF MULCH AROUND THE MOUND AND TO THE TOP OF THE RIP-RAP HINGE. THE PLANT CONTRACTOR SHALL COORDINATE WITH GARY WITTWER TO PERFORM PERCOLATION TESTS PRIOR TO PLACING LANDSCAPING ITEMS.

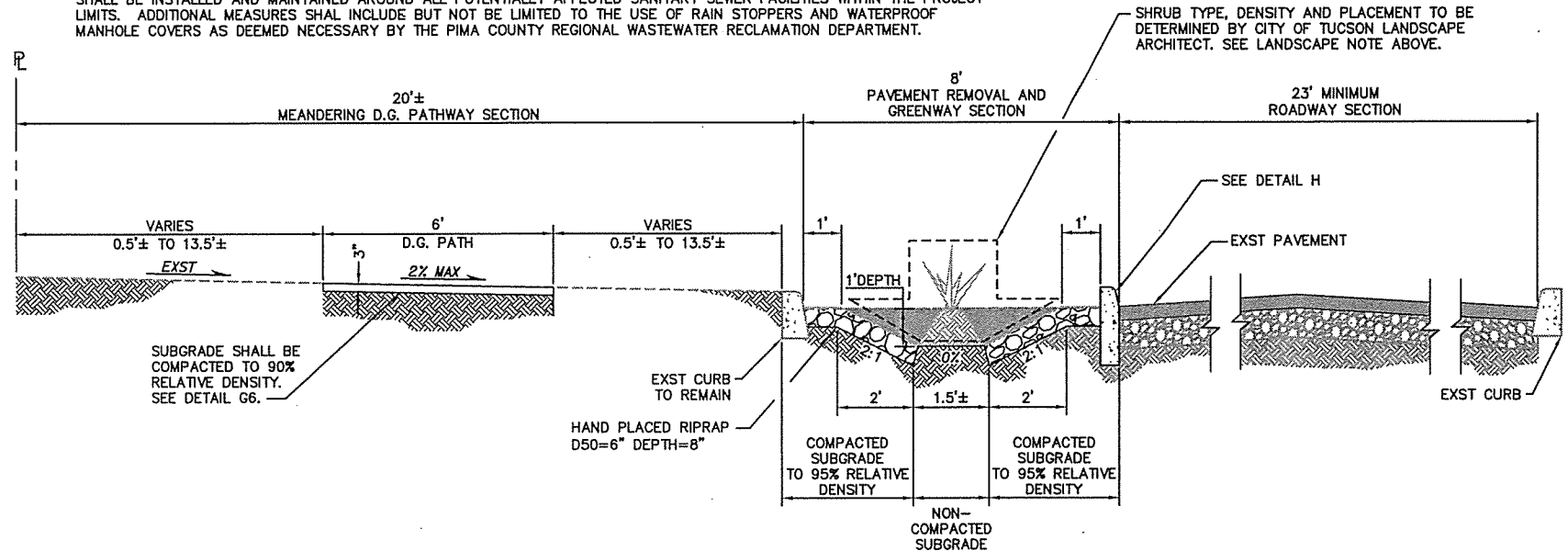

5TH AVENUE PEDESTRIAN PATH AT GREENWAY TYPICAL SECTION

NTS

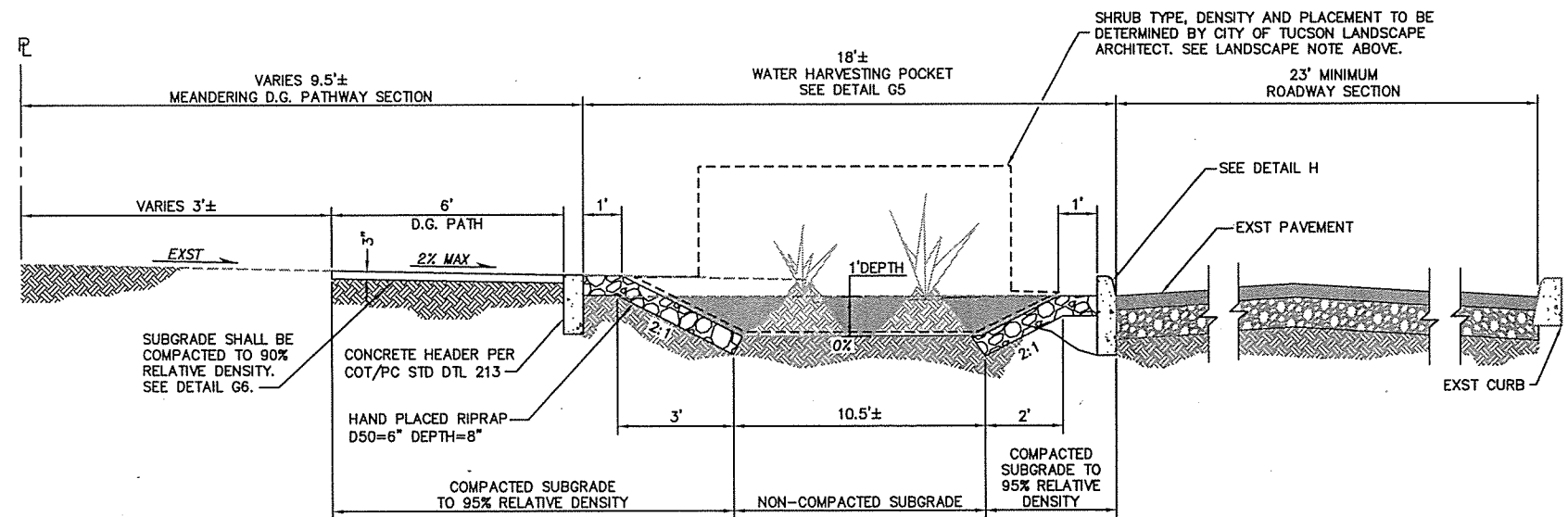

5TH AVENUE PEDESTRIAN PATH AT GREENWAY COLLECTOR TYPICAL SECTION

NTS

## GENERAL NOTES AND TYPICAL SECTIONS

DEPARTMENT OF TRANSPORTATION/ENGINEERING DIVISION  
NORTHWEST NEIGHBORHOOD PIMA COUNTY  
NEIGHBORHOOD REINVESTMENT GRANT PROJECT

2  
OF  
11

CITY OF TUCSON  
DRAWN BY: S. Shellenberger 7/2010  
DESIGN BY: R. Solis 7/2010  
CHECKED BY: R. Solis 7/2010  
REF. SCALE: N/A  
PLAN NO. U-2010-001

Kimley-Horn  
and Associates, Inc.  
© 2010 KIMLEY-HORN AND ASSOCIATES, INC.  
2210 East Fort Lowell Road, Suite 200  
Tucson, Arizona 85719 (520) 615-9191

NO. DATE REVISION BY CHKD. APPR.

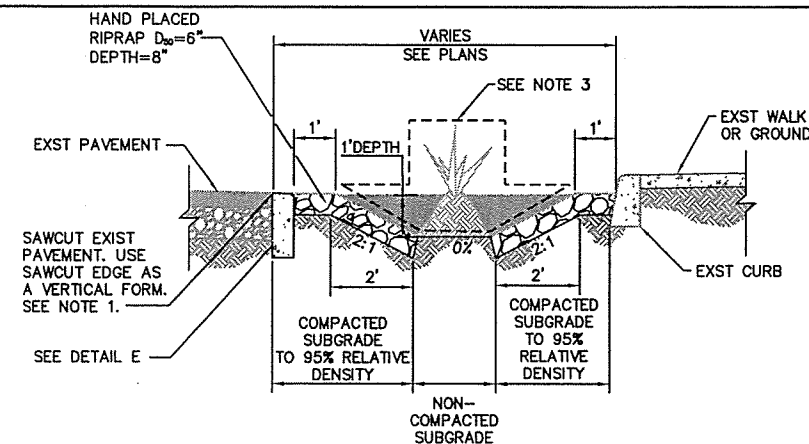

**D** **HEADER CHICANE CROSS-SECTION** NT:

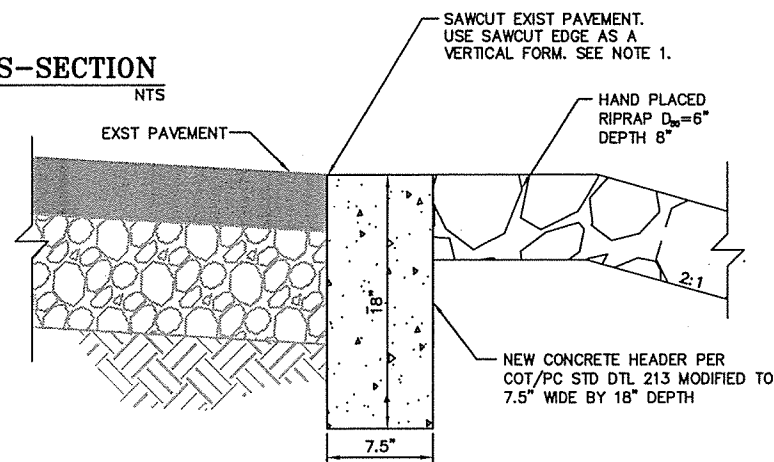

**E HEADER CHICANE CROSS-SECTION** NTS

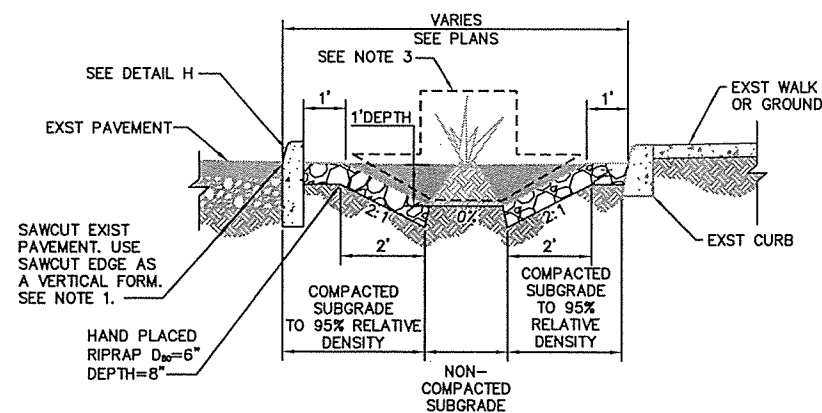

**F CURBED CHICANE CROSS-SECTION** NTS

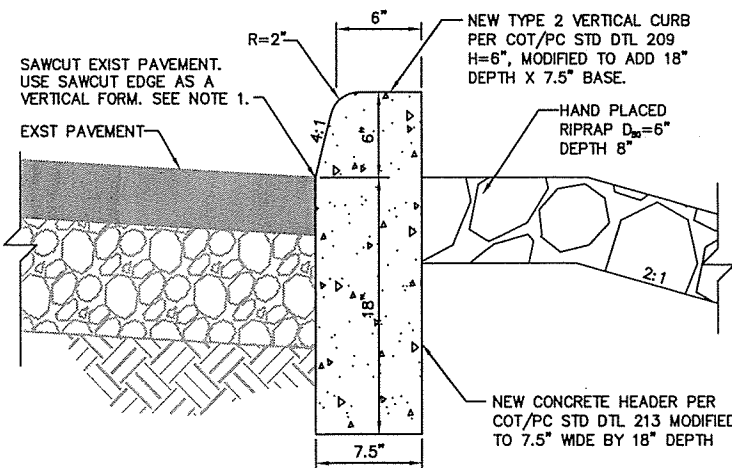

**(H) CURBED CHICANE CROSS-SECTION** NTS

**NOTES:**

1. THE CONTRACTOR SHALL UTILIZE THE SAWCUT EDGE AS A FORM FOR LONGITUDINAL CURB CONSTRUCTION. THE CONTRACTOR SHALL BE MADE RESPONSIBLE FOR THE REPLACEMENT OF ANY ASPHALT DISTURBED OUTSIDE OF THE PROJECT SAWCUT SECTION. THIS ADDITIONAL ASPHALT SHALL BE CONSIDERED INCIDENTAL TO THE CURB ITEM. ALL ASPHALT REPLACEMENT SHALL BE FULL DEPTH ASPHALT, PAG 2 MIX.
2. THE PLAN QUANTITIES ACCOUNT FOR THE REPLACEMENT OF FULL DEPTH ASPHALT, PAG 2 MIX, AROUND THE CURVED CURB SECTIONS WHERE SQUARE SAWCUT EDGES ARE ASSUMED.
3. LANDSCAPING ITEMS, QUANTITIES, AND CONSTRUCTION PROCEDURES ARE TO BE COORDINATED THROUGH THE CITY OF TUCSON LANDSCAPE ARCHITECT GARY WITTMER (520-791-5100). QUANTITIES AND PLANT TYPES WILL BE IDENTIFIED BY THE CITY OF TUCSON. THESE TYPICAL SECTIONS SHOW THE GENERAL LOCATION OF PLANTING(S), A PLANT MOUND, AND THE PLACEMENT OF MULCH AROUND THE MOUND AND TO THE TOP OF THE RIP-RAP HINGE. THE PLANT CONTRACTOR SHALL COORDINATE WITH GARY WITTMER TO PERFORM PERCOLATION TESTS PRIOR TO PLACING LANDSCAPING ITEMS.

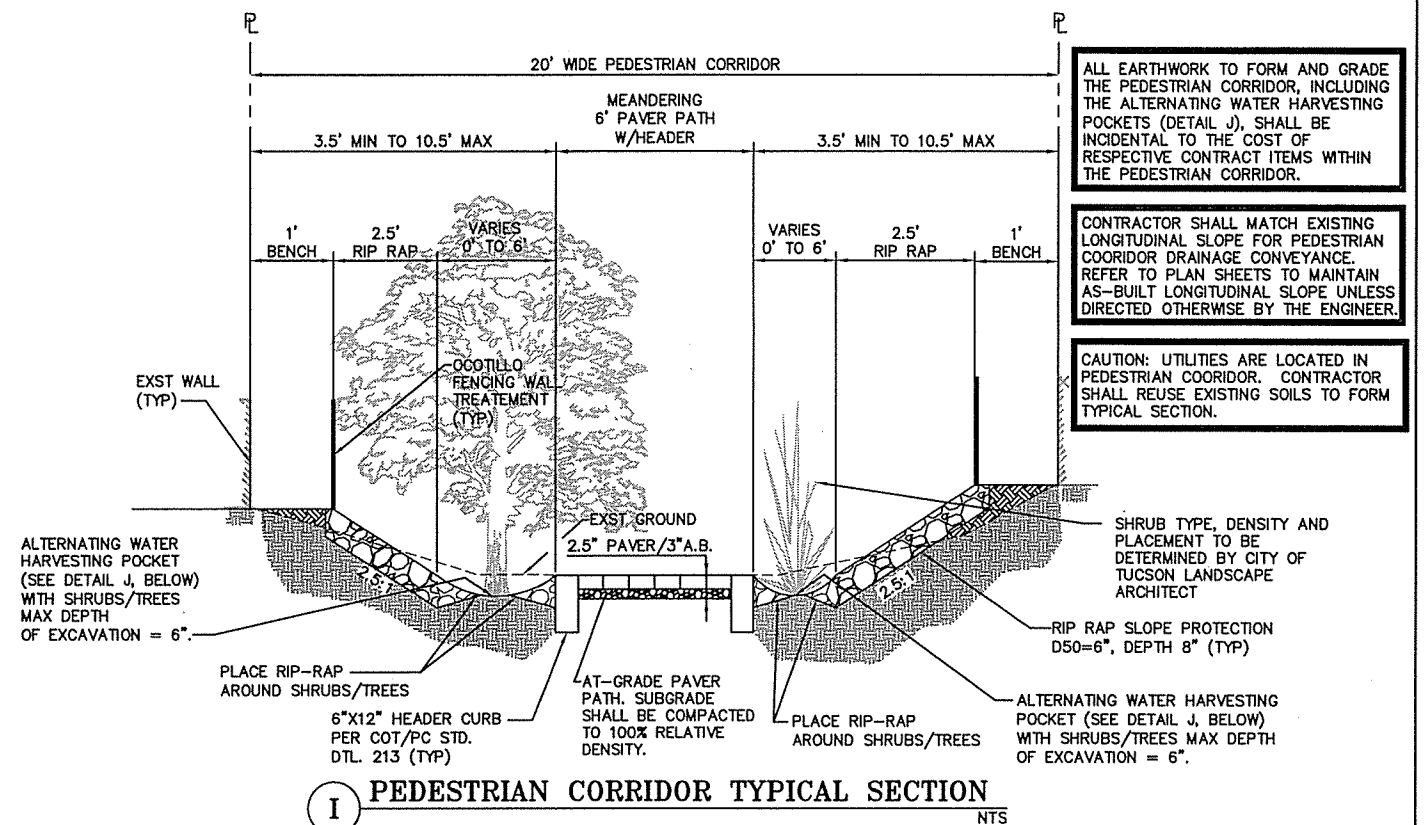

**I PEDESTRIAN CORRIDOR TYPICAL SECTION**

LANDSCAPING ITEMS, QUANTITIES, AND CONSTRUCTION PROCEDURES ARE TO BE COORDINATED THROUGH THE CITY OF TUCSON LANDSCAPE ARCHITECT GARY WITWER (520-791-5100). QUANTITIES AND PLANT TYPES WILL BE IDENTIFIED BY THE CITY OF TUCSON. THIS TYPICAL SECTION SHOWS THE GENERAL LOCATION OF PLANTING(S), A PLANT MOUND, AND THE PLACEMENT OF MULCH AROUND THE MOUND AND TO THE TOP OF THE RIP-RAP HINGE. THE PLANT CONTRACTOR SHALL COORDINATE WITH GARY WITWER TO PERFORM PERCOLATION TESTS PRIOR TO PLACING LANDSCAPING ITEMS.

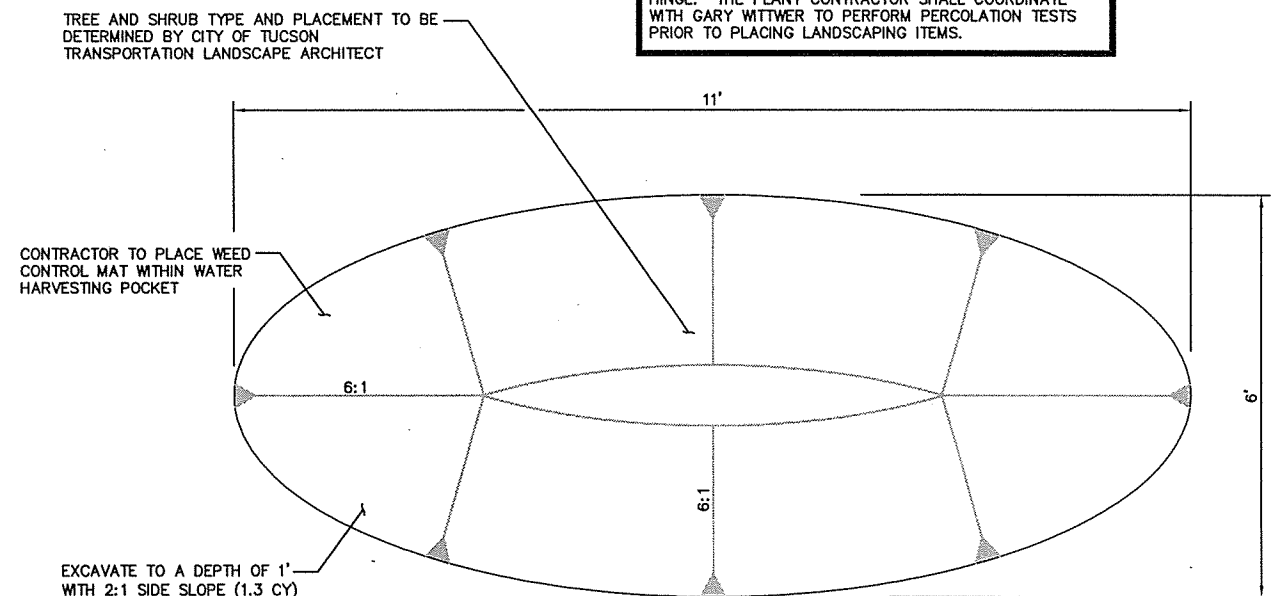

## J ALTERNATING WATER HARVESTING POCKET

### TYPICAL AND CROSS SECTIONS

DEPARTMENT OF TRANSPORTATION/ENGINEERING DIVISION NORTHWEST NEIGHBORHOOD PIMA COUNTY NEIGHBORHOOD REINVESTMENT GRANT PROJECT
--

[illegible]

Q. 10	Q. 11	Q. 12	Q. 13	Q. 14	Q. 15	Q. 16	Q. 17	Q. 18	Q. 19	Q. 20	Q. 21	Q. 22	Q. 23	Q. 24	Q. 25	Q. 26	Q. 27	Q. 28	Q. 29	Q. 30	Q. 31	Q. 32	Q. 33	Q. 34	Q. 35	Q. 36	Q. 37	Q. 38	Q. 39	Q. 40	Q. 41	Q. 42	Q. 43	Q. 44	Q. 45	Q. 46	Q. 47	Q. 48	Q. 49	Q. 50	Q. 51	Q. 52	Q. 53	Q. 54	Q. 55	Q. 56	Q. 57	Q. 58	Q. 59	Q. 60	Q. 61	Q. 62	Q. 63	Q. 64	Q. 65	Q. 66	Q. 67	Q. 68	Q. 69	Q. 70	Q. 71	Q. 72	Q. 73	Q. 74	Q. 75	Q. 76	Q. 77	Q. 78	Q. 79	Q. 80	Q. 81	Q. 82	Q. 83	Q. 84	Q. 85	Q. 86	Q. 87	Q. 88	Q. 89	Q. 90	Q. 91	Q. 92	Q. 93	Q. 94	Q. 95	Q. 96	Q. 97	Q. 98	Q. 99	Q. 100
-------	-------	-------	-------	-------	-------	-------	-------	-------	-------	-------	-------	-------	-------	-------	-------	-------	-------	-------	-------	-------	-------	-------	-------	-------	-------	-------	-------	-------	-------	-------	-------	-------	-------	-------	-------	-------	-------	-------	-------	-------	-------	-------	-------	-------	-------	-------	-------	-------	-------	-------	-------	-------	-------	-------	-------	-------	-------	-------	-------	-------	-------	-------	-------	-------	-------	-------	-------	-------	-------	-------	-------	-------	-------	-------	-------	-------	-------	-------	-------	-------	-------	-------	-------	-------	-------	-------	-------	-------	-------	--------

© 2011 Blackwell Publishing Ltd *Journal of Internal Medicine* 270: 111–120

**Lessons**

1

DRWN. BY S. Sha

7/2010

1. *Journal of the American Medical Association*, 2000; 284: 2689-2694.

1

100



© 2010 KIMLEY-HORN AND ASSOCIATES, INC.

2210 East Fort Lowell Road, Suite 200  
Tucson, Arizona 85719 (520) 615-9191

Tucson, Arizona 85719 (520) 615-9191

NO.	DATE	REVISION	BY	CHKD.	APPR.
-----	------	----------	----	-------	-------

\\TUC\_Roadway\090134005\_Northwest Neighborhood Grant\CA00\134005TYP02.dwg Jul 15, 2010 rtk.aeflle  
REF: x134005P00 x134005M01

TWO WORKING DAYS BEFORE YOU CAN  
CALL FOR THE BLUE STAMPS  
**800-782-5348**  
ARIZONA BLUE STAMP CENTER  
WELL PRIDE

3  
OF  
1

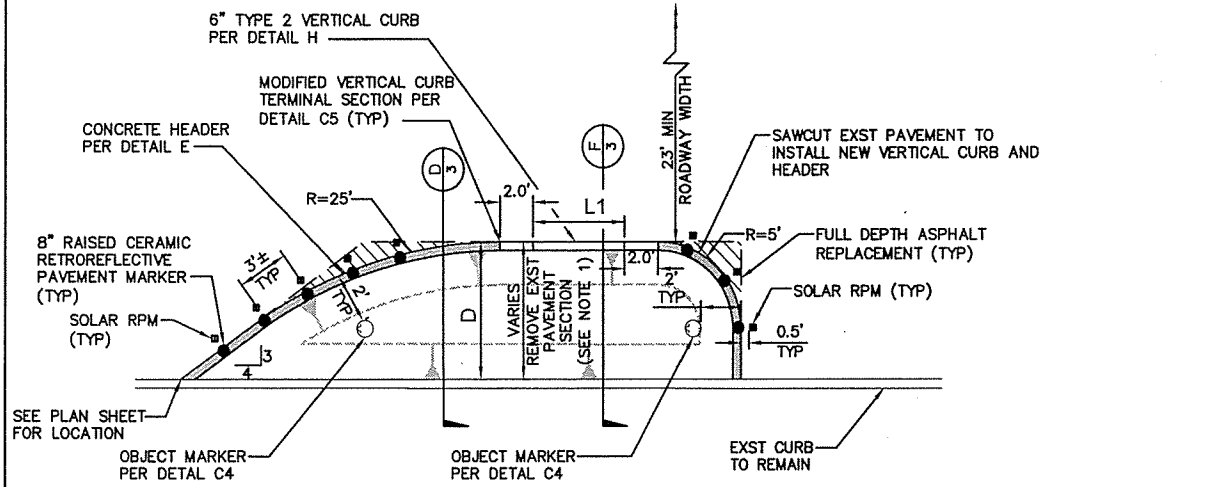

TYPE	QUANTITY	D (FT)	L1 (FT)	SAWCUT (FT)	AC REMOVAL (SY)	HEADER (FT)	CURB (FT)	TERMINAL SECTION (EA)	STREET
C1A	3	10	5.5	50	33	38	5.5	2	ELM ST
C1B	5	8	5.5	45	26	33	5.5	2	ELM ST
C1C	1	8	5.5	45	26	33	5.5	2	5TH AVE

- NOTES:
- CONTRACTOR SHALL USE SAWCUT EDGE TO FORM NEW CONCRETE HEADER OR NEW VERTICAL CURB WHERE POSSIBLE. THE CONTRACTOR SHALL BE MADE RESPONSIBLE FOR THE REPLACEMENT OF ANY ASPHALT DISTURBED OUTSIDE OF THE PROJECT SAWCUT SECTION. THIS ADDITIONAL ASPHALT SHALL BE CONSIDERED INCIDENTAL TO THE CURB ITEM. ALL ASPHALT REPLACEMENT SHALL BE FULL DEPTH ASPHALT, PAG 2 MIX.
  - CONTRACTOR SHALL COMPACT SOIL AT ALL NEW CURB LOCATIONS AND AREAS WHERE FULL DEPTH ASPHALT WILL BE PLACED.
  - RAISED PAVEMENT MARKERS SHALL NOT BE PLACED WITHIN PROPOSED DRIVE PATH.
  - ALL SPECIFICATIONS FOR SOLAR RPM'S AND CERAMIC DOMES SHALL BE OBTAINED FROM CITY OF TUCSON ENGINEER.
  - ALL PROPOSED FACE OF CURB SHALL REMAIN 1 FOOT MINIMUM FROM EXISTING WATER LINES
  - THE PLAN QUANTITIES ACCOUNT FOR THE REPLACEMENT OF FULL DEPTH ASPHALT, PAG 2 MIX, AROUND THE CURVED CURB SECTIONS WHERE SQUARE SAWCUT EDGES ARE ASSUMED.

**DETAIL C1**  
MID-BLOCK CHICANE TYPE 1  
(N.T.S.)

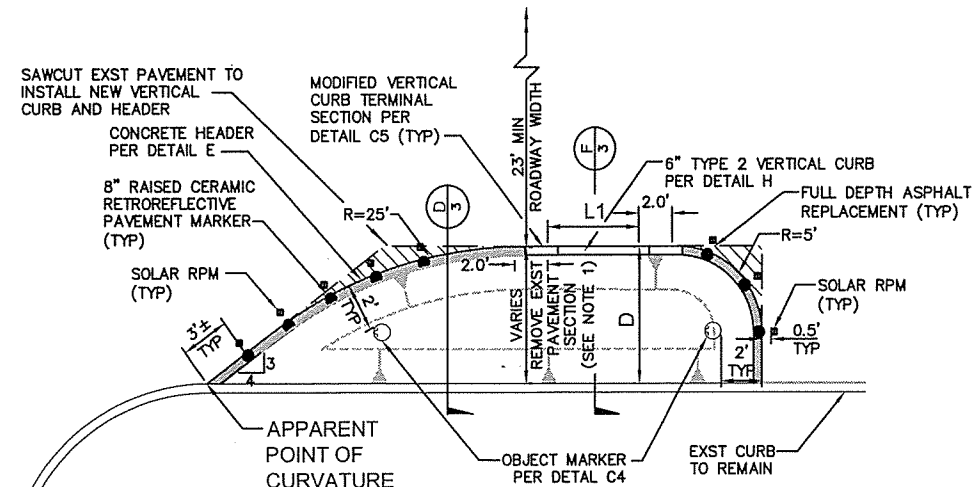

TYPE	QUANTITY	D (FT)	L1 (FT)	SAWCUT (FT)	AC REMOVAL (SY)	HEADER (FT)	CURB (FT)	TERMINAL SECTION (EA)	STREET
C2A	2	10	5.5	50	33	38	5.5	2	ELM ST
C2B	1	8	5.5	45	26	33	5.5	2	ELM ST
C2C	4	8	5.5	45	26	33	5.5	2	5TH AVE

- NOTES:
- CONTRACTOR SHALL USE SAWCUT EDGE TO FORM NEW CONCRETE HEADER OR NEW VERTICAL CURB WHERE POSSIBLE. THE CONTRACTOR SHALL BE MADE RESPONSIBLE FOR THE REPLACEMENT OF ANY ASPHALT DISTURBED OUTSIDE OF THE PROJECT SAWCUT SECTION. THIS ADDITIONAL ASPHALT SHALL BE CONSIDERED INCIDENTAL TO THE CURB ITEM. ALL ASPHALT REPLACEMENT SHALL BE FULL DEPTH ASPHALT, PAG 2 MIX.
  - CONTRACTOR SHALL COMPACT SOIL AT ALL NEW CURB LOCATIONS AND AREAS WHERE FULL DEPTH ASPHALT WILL BE PLACED.
  - RAISED PAVEMENT MARKERS SHALL NOT BE PLACED WITHIN PROPOSED DRIVE PATH.
  - ALL SPECIFICATIONS FOR SOLAR RPM'S AND CERAMIC DOMES SHALL BE OBTAINED FROM CITY OF TUCSON ENGINEER.
  - ALL PROPOSED FACE OF CURB SHALL REMAIN 1 FOOT MINIMUM FROM EXISTING WATER LINES.
  - THE PLAN QUANTITIES ACCOUNT FOR THE REPLACEMENT OF FULL DEPTH ASPHALT, PAG 2 MIX, AROUND THE CURVED CURB SECTIONS WHERE SQUARE SAWCUT EDGES ARE ASSUMED.

**DETAIL C2**  
INTERSECTION CHICANE TYPE 2  
(N.T.S.)

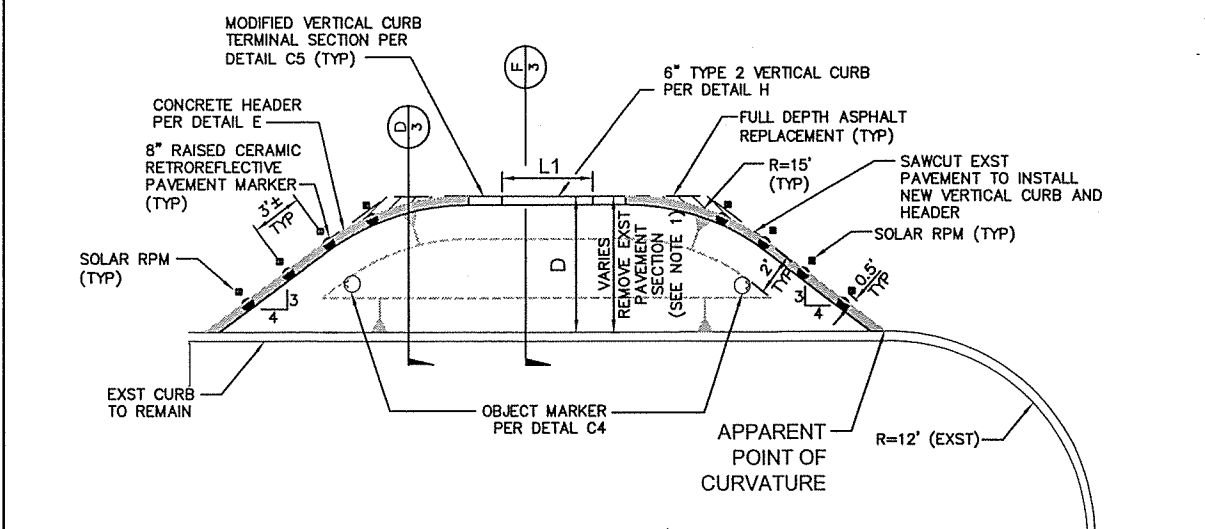

TYPE	QUANTITY	D	L1 (FT)	SAWCUT (FT)	AC REMOVAL (SY)	HEADER (FT)	CURB (FT)	TERMINAL SECTION (EA)	STREET
C3A	2	10	5.5	53	37	43	5.5	2	ELM ST
C3B	1	8	5.5	47	27	36	5.5	2	ELM ST

- NOTES:
- CONTRACTOR SHALL USE SAWCUT EDGE TO FORM NEW CONCRETE HEADER OR NEW VERTICAL CURB WHERE POSSIBLE. THE CONTRACTOR SHALL BE MADE RESPONSIBLE FOR THE REPLACEMENT OF ANY ASPHALT DISTURBED OUTSIDE OF THE PROJECT SAWCUT SECTION. THIS ADDITIONAL ASPHALT SHALL BE CONSIDERED INCIDENTAL TO THE CURB ITEM. ALL ASPHALT REPLACEMENT SHALL BE FULL DEPTH ASPHALT, PAG 2 MIX.
  - CONTRACTOR SHALL COMPACT SOIL AT ALL NEW CURB LOCATIONS AND AREAS WHERE FULL DEPTH ASPHALT WILL BE PLACED.
  - RAISED PAVEMENT MARKERS SHALL NOT BE PLACED WITHIN PROPOSED DRIVE PATH.
  - ALL SPECIFICATIONS FOR SOLAR RPM'S AND CERAMIC DOMES SHALL BE OBTAINED FROM CITY OF TUCSON ENGINEER.
  - ALL PROPOSED FACE OF CURB SHALL REMAIN 1 FOOT MINIMUM FROM EXISTING WATER LINES
  - THE PLAN QUANTITIES ACCOUNT FOR THE REPLACEMENT OF FULL DEPTH ASPHALT, PAG 2 MIX, AROUND THE CURVED CURB SECTIONS WHERE SQUARE SAWCUT EDGES ARE ASSUMED.

**DETAIL C3**  
INTERSECTION CHICANE TYPE 3  
(N.T.S.)

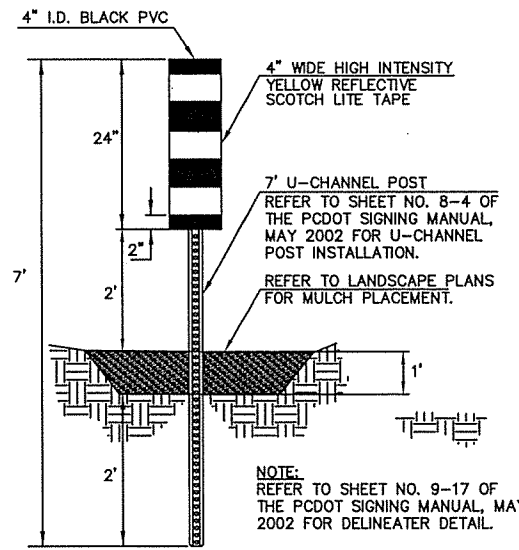

**DETAIL C4**  
OBJECT MARKER  
(N.T.S.)

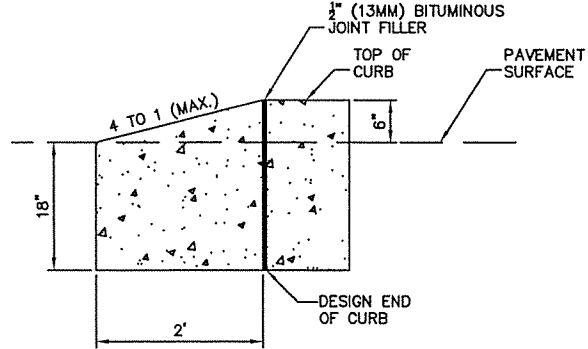

**DETAIL C5**  
MODIFIED COT/PC STD DTL  
212 VERTICAL CURB  
TERMINAL SECTION  
(N.T.S.)

CONSTRUCTION DETAILS

DEPARTMENT OF TRANSPORTATION/ENGINEERING DIVISION		4 OF 11	
NORTHWEST NEIGHBORHOOD PIMA COUNTY			
NEIGHBORHOOD REINVESTMENT GRANT PROJECT			
CITY OF TUCSON	DRWN. BY S. Shellenberger	7/2010	REF. SCALE: N/A
	DSGN. BY R. Sells	7/2010	
	CHKD. BY R. Sells	7/2010	PLAN NO. U-2010-001

Kimley-Horn and Associates, Inc.	
© 2010 KIMLEY-HORN AND ASSOCIATES, INC.	
2210 East Fort Lowell Road, Suite 200	
Tucson, Arizona 85719 (520) 615-9191	
NO.	DATE
REVISION	BY
CHKD.	APPR.

AC:\TUC\Roadway\000134005\_Northwest\_Neighborhood\_Grant\CD\U-2010-001.dwg Jd 15, 2010 10:40:40  
 PLOT: 10-14-2010 10:40:40 PLOT: 10-14-2010 10:40:40

THE EXPIRATION DATE BEFORE YOU CAN  
 CALL FOR THE BLUE STAMP  
**800-782-5348**  
 ARIZONA BLUE STAMP CENTER  
 TELL FREE



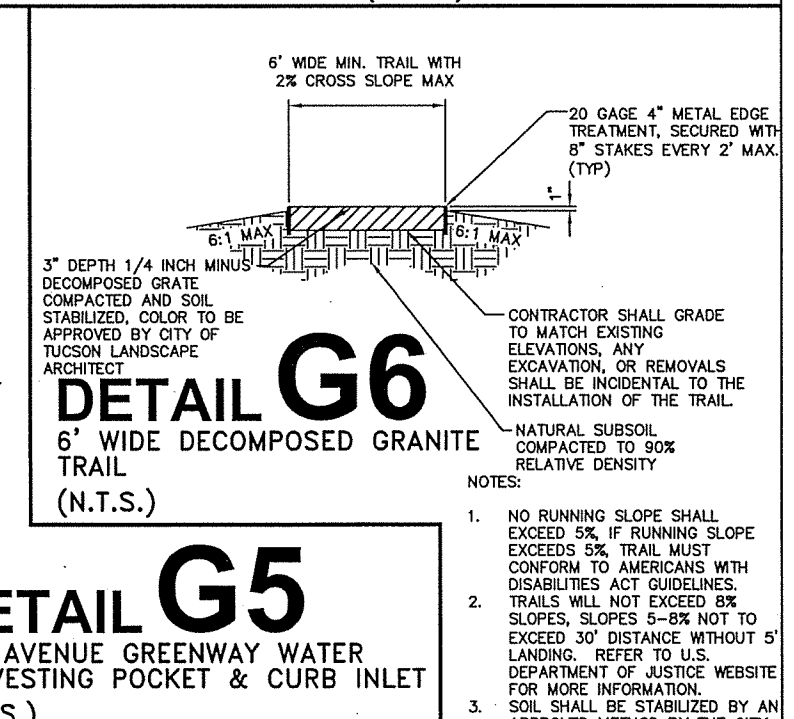
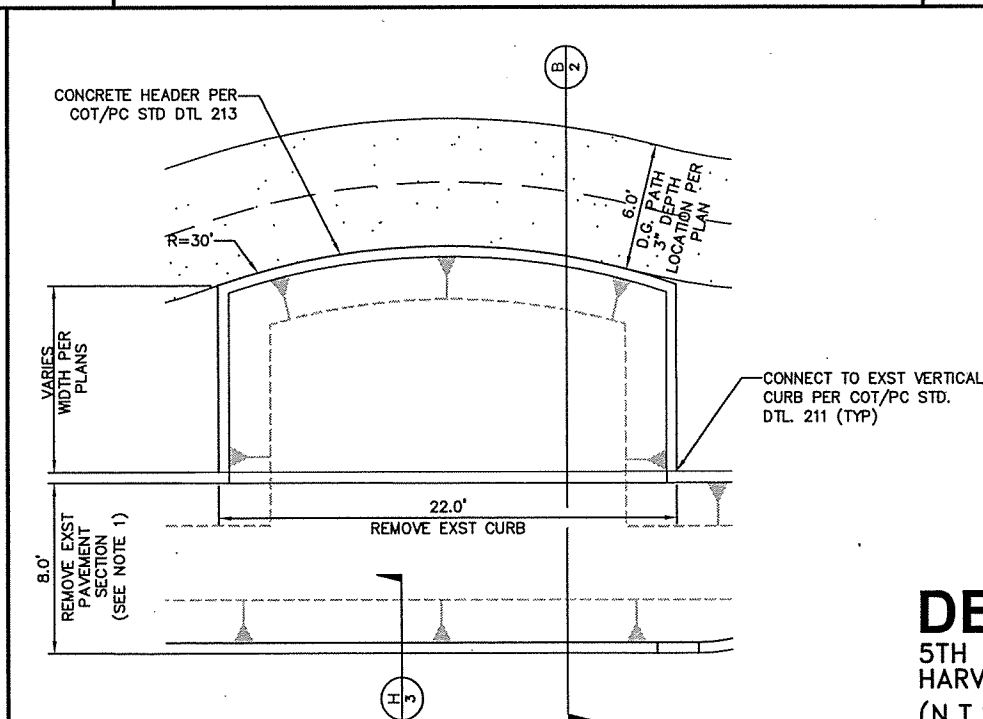
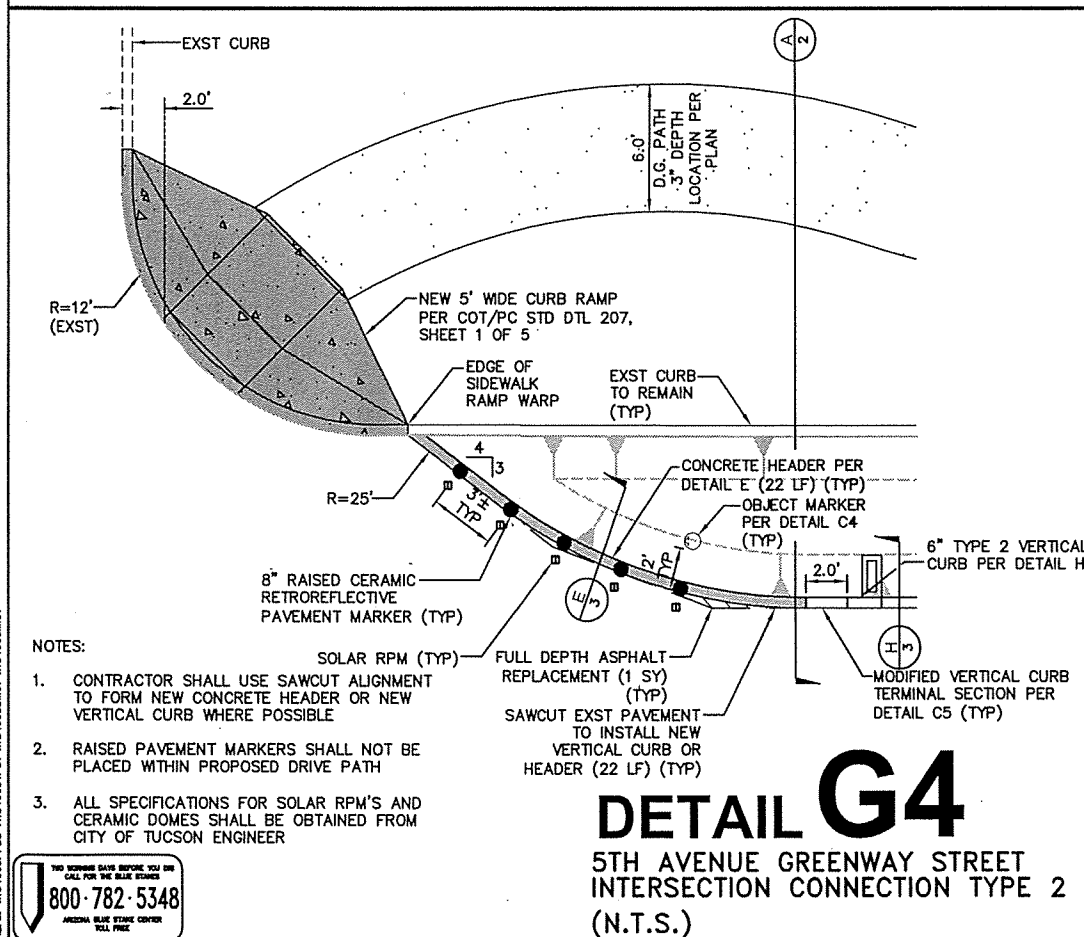
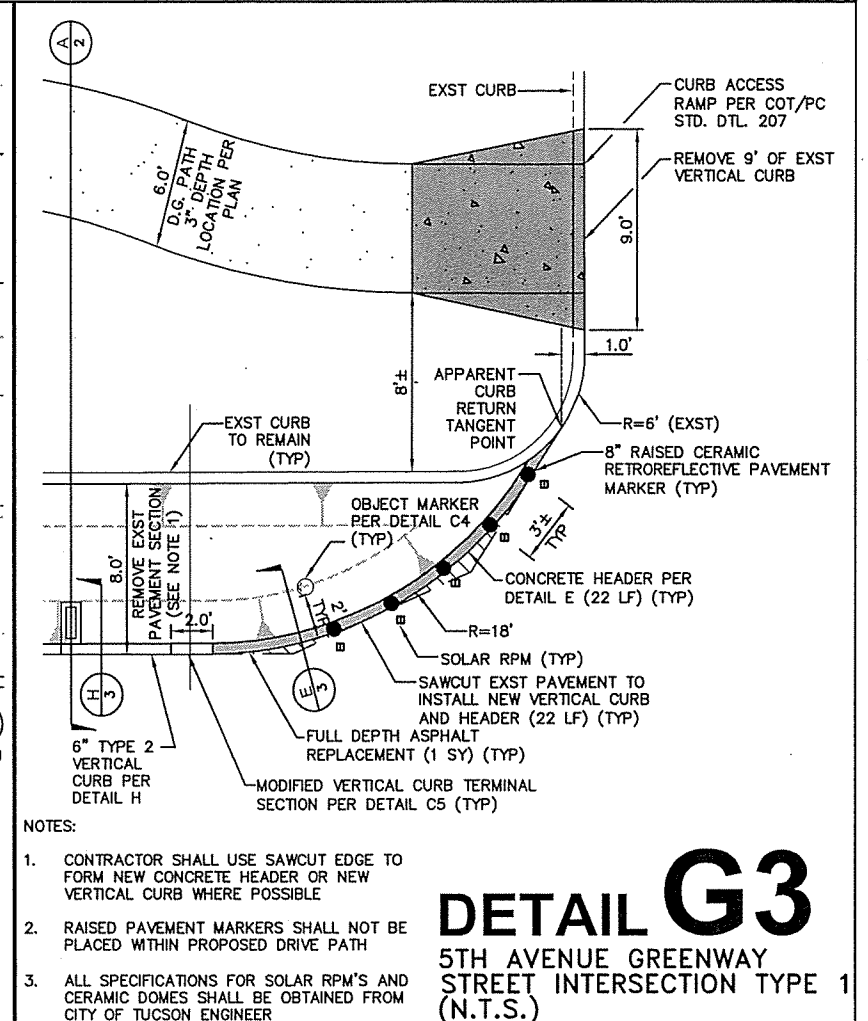
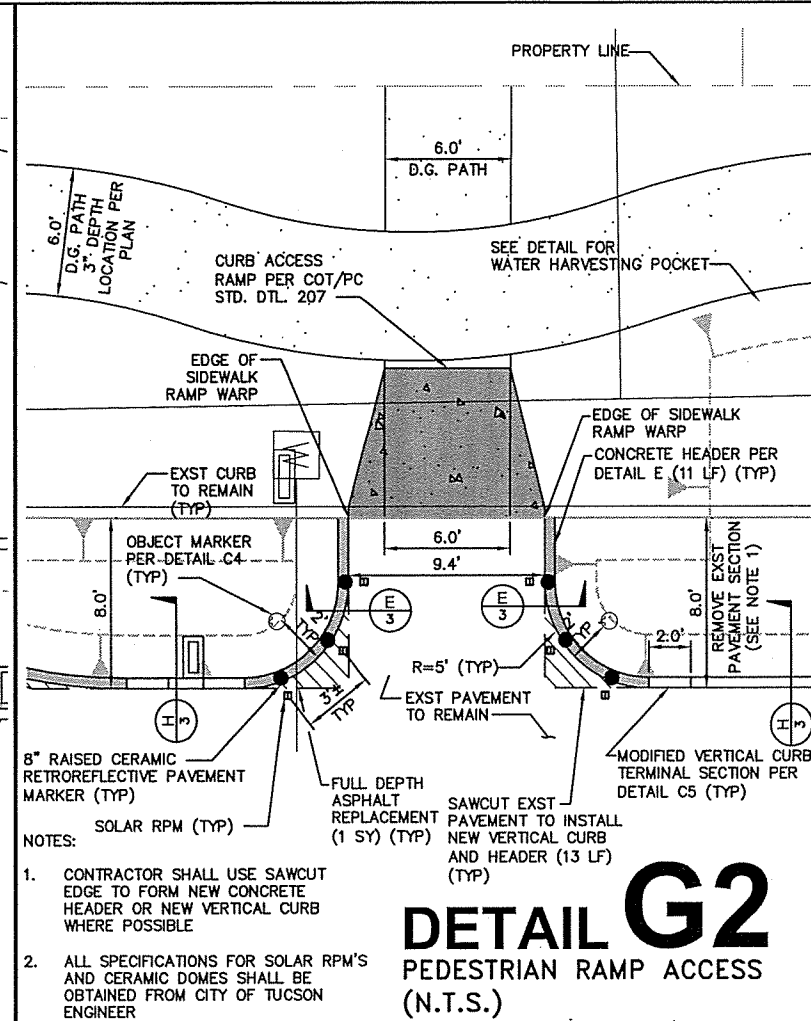
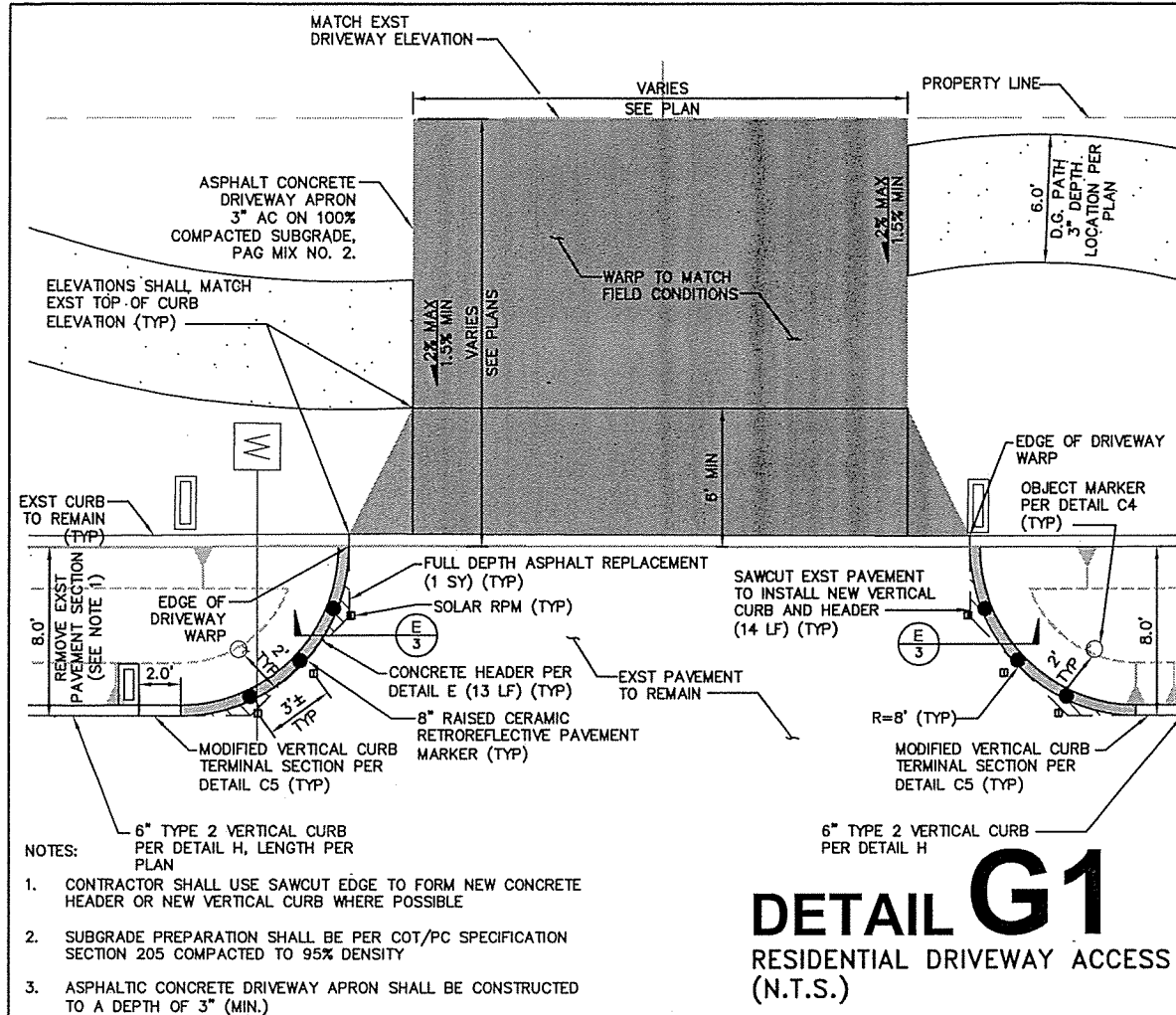

**DETAIL G5**  
5TH AVENUE GREENWAY WATER  
HARVESTING POCKET & CURB INLET  
(N.T.S.)

**DETAIL G6**  
6' WIDE DECOMPOSED GRANITE  
TRAIL  
(N.T.S.)

- NOTES:
1. NO RUNNING SLOPE SHALL EXCEED 5%, IF RUNNING SLOPE EXCEEDS 5%, TRAIL MUST CONFORM TO AMERICANS WITH DISABILITIES ACT GUIDELINES. TRAILS WILL NOT EXCEED 8% SLOPES, SLOPES 5-8% NOT TO EXCEED 30' DISTANCE WITHOUT 5' LANDING. REFER TO U.S. DEPARTMENT OF JUSTICE WEBSITE FOR MORE INFORMATION.
  2. SOIL SHALL BE STABILIZED BY AN APPROVED METHOD BY THE CITY OF TUCSON.

CONSTRUCTION DETAILS

**Kimley-Horn and Associates, Inc.**  
2210 East Fort Lowell Road, Suite 200  
Tucson, Arizona 85719 (520) 615-9191

DEPARTMENT OF TRANSPORTATION/ENGINEERING DIVISION  
NORTHWEST NEIGHBORHOOD PIMA COUNTY  
NEIGHBORHOOD REINVESTMENT GRANT PROJECT

CITY OF TUCSON

DRWN. BY: S. Shellenbarger 7/2010  
DSGN. BY: R. Sells 7/2010  
CHKD. BY: R. Sells 7/2010

REF. SCALE: N/A  
PLAN NO. U-2010-001

NO. DATE REVISION BY CHKD. APPR.

800-782-5348

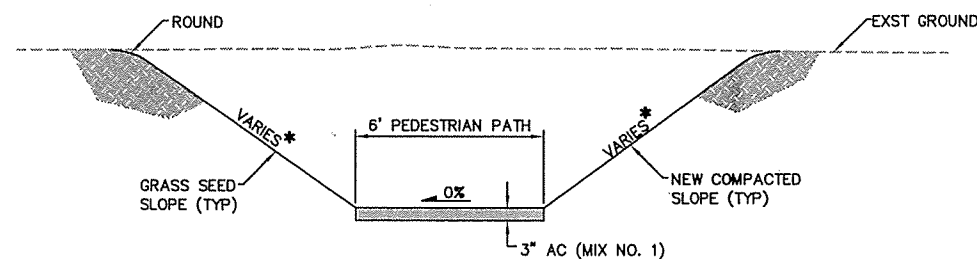
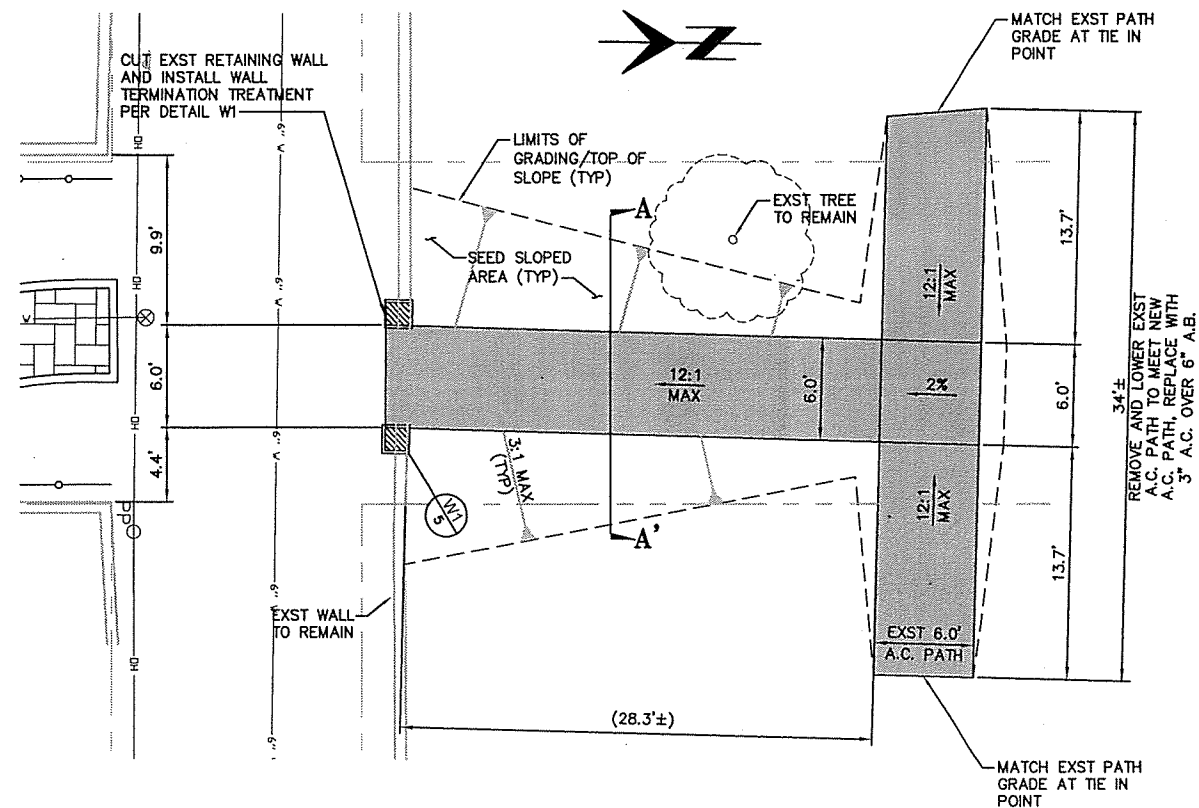

SECTION A-A'

- \* CONTRACTOR TO COORDINATE WITH COT PARKS AND REC. TO DETERMINE SLOPE ALTERNATIVES:
- 4:1 SLOPE CAN BE GRASS SEED
  - 3:1 SLOPE MUST BE COVERED WITH HAND PLACE RIPRAP  $D_{max}=6"$

NOTE: WALL COLUMNS AND PEDESTRIAN RAMP AND PATH SHALL BE BID AS A SINGLE LUMP SUM ITEM, COMPLETE IN PLACE.

## DETAIL W2

PARK RAMP & PED PATH (N.T.S.)

RAMP AND WALL MODIFICATIONS FOR THE CONNECTION WITH THE PEDESTRIAN CORRIDOR TO MANSFELD PARK WILL BE DONE IN COORINATION WITH THE CITY OF TUCSON PARKS AND RECREATION DEPARTMENT, AND WILL BE A SEPERATE PHASE OF THIS PROJECT.

NOTE: WALL COLUMNS AND PEDESTRIAN RAMP AND PATH SHALL BE BID AS A SINGLE LUMP SUM ITEM, COMPLETE IN PLACE.

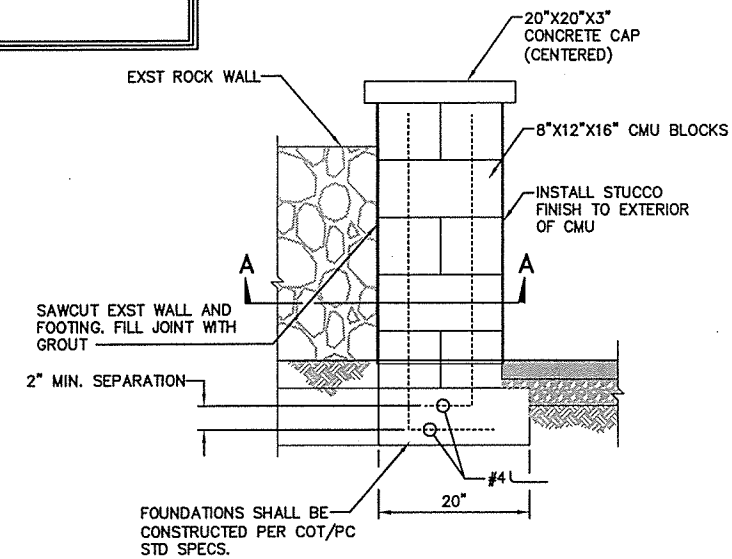

PIER AT PARK ENTRANCE

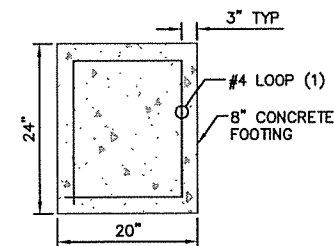

PIER FOOTING

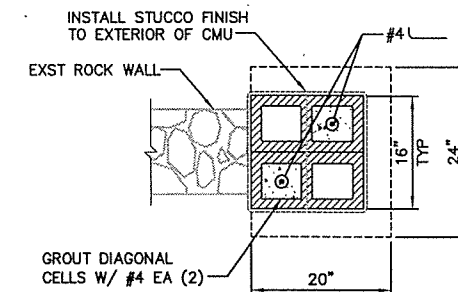

SECTION A-A'

## DETAIL W1

WALL TERMINATION TREATMENT (N.T.S.)

RAMP AND WALL MODIFICATIONS FOR THE CONNECTION WITH THE PEDESTRIAN CORRIDOR TO MANSFELD PARK WILL BE DONE IN COORINATION WITH THE CITY OF TUCSON PARKS AND RECREATION DEPARTMENT, AND WILL BE A SEPERATE PHASE OF THIS PROJECT.

CONSTRUCTION DETAILS

**Kimley-Horn and Associates, Inc.**  
 2210 East Fort Lowell Road, Suite 200  
 Tucson, Arizona 85719 (520) 615-9191

DEPARTMENT OF TRANSPORTATION/ENGINEERING DIVISION				6 OF 11
NORTHWEST NEIGHBORHOOD PIMA COUNTY NEIGHBORHOOD REINVESTMENT GRANT PROJECT				
 CITY OF TUCSON	DRWN. BY S. Shellenberger	7/2010	REF. _____	SCALE: N/A
	DSGN. BY R. Sells	7/2010		
	CHKD. BY R. Sells	7/2010	PLAN NO. U-2010-001	

NO.	DATE	REVISION	BY	CHKD.	APPR.
-----	------	----------	----	-------	-------

# CONSTRUCTION NOTES:

1. INSTALL NEW CHICANE PER DETAILS C1, C2 OR C3. INSTALL CHICANE TYPE AS INDICATED ON PLAN.
2. INSTALL ASPHALTIC CONCRETE RESIDENTIAL DRIVEWAY ACCESS PER DETAIL G1. INSTALL DRIVEWAY FROM BACK OF EXISTING CURB TO EXISTING PROPERTY LINE.
3. INSTALL GREENWAY WATER HARVESTING POCKET PER DETAIL G5.
4. INSTALL 6" WIDE CURB RAMP PER COT/PC STD. DTL. 207 AND GREENWAY STREET INTERSECTION CONNECTION TYPE 1 PER DETAIL G3.
5. INSTALL 5' WIDE CURB RAMP PER COT/PC STD. DTL. 207 AND GREENWAY STREET INTERSECTION CONNECTION TYPE 2 PER DETAIL G4.
6. INSTALL 6' WIDE PEDESTRIAN RAMP ACCESS PER DETAIL G2.
7. INSTALL 6' MEANDERING STABILIZED DECOMPOSED GRANITE PATH (3" DEPTH) PER DETAIL G6. CENTERLINE RADIUS BETWEEN 25' AND 50'.
8. INSTALL CURB ACCESS RAMP PER ADOT STD. DTL. C-05.30 TYPE E.
9. INSTALL 6' PAVR PATH WITH 6"x12" CONCRETE HEADER PER COT/PC STD. DTL. 201 AND TYPICAL SECTION ON THESE PLANS. CENTERLINE RADIUS SHALL BE APPROX. 25'.
10. INSTALL 8' WIDE GREENWAY PER TYPICAL SECTION A & B. 6" VERTICAL CURB AND SAWCUT LENGTHS PER PLAN (EXCLUDES 2' CURB END TERMINALS).
11. INSTALL 6" THICK CONCRETE SLAB ON GRADE. CONSTRUCT WITH JOINTS AT 10' INTERVALS FILLED WITH BITUMINOUS JOINT FILLER. REMOVE EXISTING ASPHALT CONCRETE, SCARIFY EXISTING AND RECOMPACT TO 95% PROCTOR DENSITY.
12. INSTALL 6"x12" CONCRETE HEADER AT TERMINATION OF 6' PAVR PATH.
13. PROTECT EXISTING FIRE HYDRANT IN PLACE.
14. ADJUST EXISTING WATER VALVE BOX AND COVER TO GRADE PER COT/PC STD. DTL. W-300.
15. RELOCATE EXISTING MAIL RECEPTACLE AND POST/SUPPORT PER COT/PC STD. DTL. 102 TO PROVIDE DRIVE-UP ACCESS BY U.S.P.S. NEW LOCATIONS ON 5TH AVENUE AND ELM STREET.
16. INSTALL OCOTILLO FENCING WALL TREATMENT 1' OFFSET FROM EXISTING WALL.
17. PROTECT EXISTING WATER VALVE/METER IN PLACE.
18. CONSTRUCT CURB INLET PER DETAIL G5.
19. PROTECT EXISTING STREET LIGHT IN PLACE.
20. ADJUST EXISTING SEWER MANHOLE TO GRADE PER COT/PC STD. DTL. WWM-304.
21. CONTRACTOR TO COORDINATE WITH SOUTHWEST GAS FOR RELOCATION OF GAS LINE.

- NOTES:
1. ALL PROPOSED FACE OF CURB SHALL REMAIN 1 FOOT MINIMUM FROM EXISTING WATER LINES.
  2. REFER TO DETAILS C1, C2, C3, G1, G2, G3, AND G4 FOR TYPICAL HEADER, SAWCUT, AND FULL DEPTH REPLACEMENT QUANTITIES.

## SERVICE WORK

CODE	ADDRESS	PIPE SIZE & QUANT. (IN FEET ±)
	METER # & SIZE	2" 1" 1 1/2" 2"
1	#07007547, 8"	20'
2	#Empty, N/A	12'
3	#83022230, 8"	16'
TOTAL QUANTITIES OF CU PIPE FOR SERVICE WORK ONLY		48'

## CONSTRUCTION PLAN SHEET

DEPARTMENT OF TRANSPORTATION/ENGINEERING DIVISION  
NORTHWEST NEIGHBORHOOD PIMA COUNTY  
NEIGHBORHOOD REINVESTMENT GRANT PROJECT



DRWN. BY S. Shellenberger 7/2010 REF. SCALE: 1"=20'  
DESIGN. BY R. Sells 7/2010  
CHKD. BY R. Sells 7/2010 PLAN NO. U-2010-001

**Kimley-Horn and Associates, Inc.**  
© 2010 KIMLEY-HORN AND ASSOCIATES, INC.  
2210 East Fort Lowell Road, Suite 200  
Tucson, Arizona 85719 (520) 615-9191

NO. DATE REVISION BY CHKD. APPR.

SEE BELOW LEFT

SEE NEXT SHEET

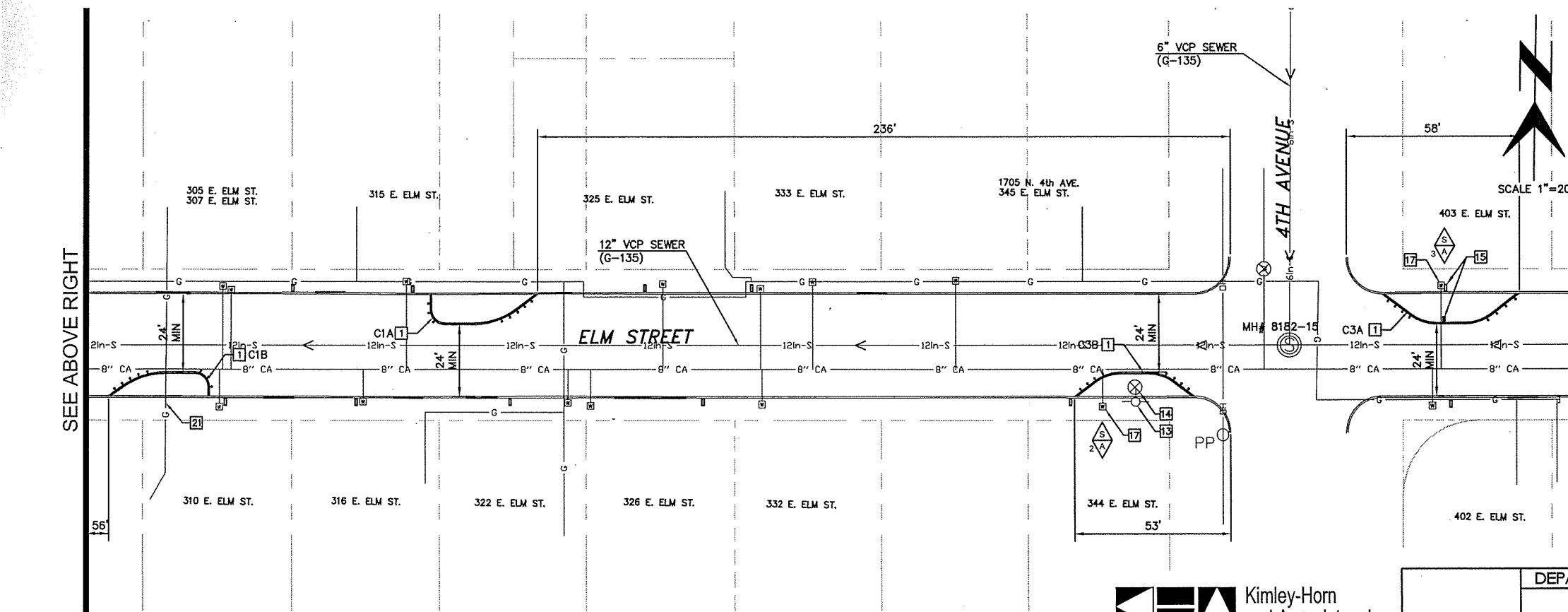
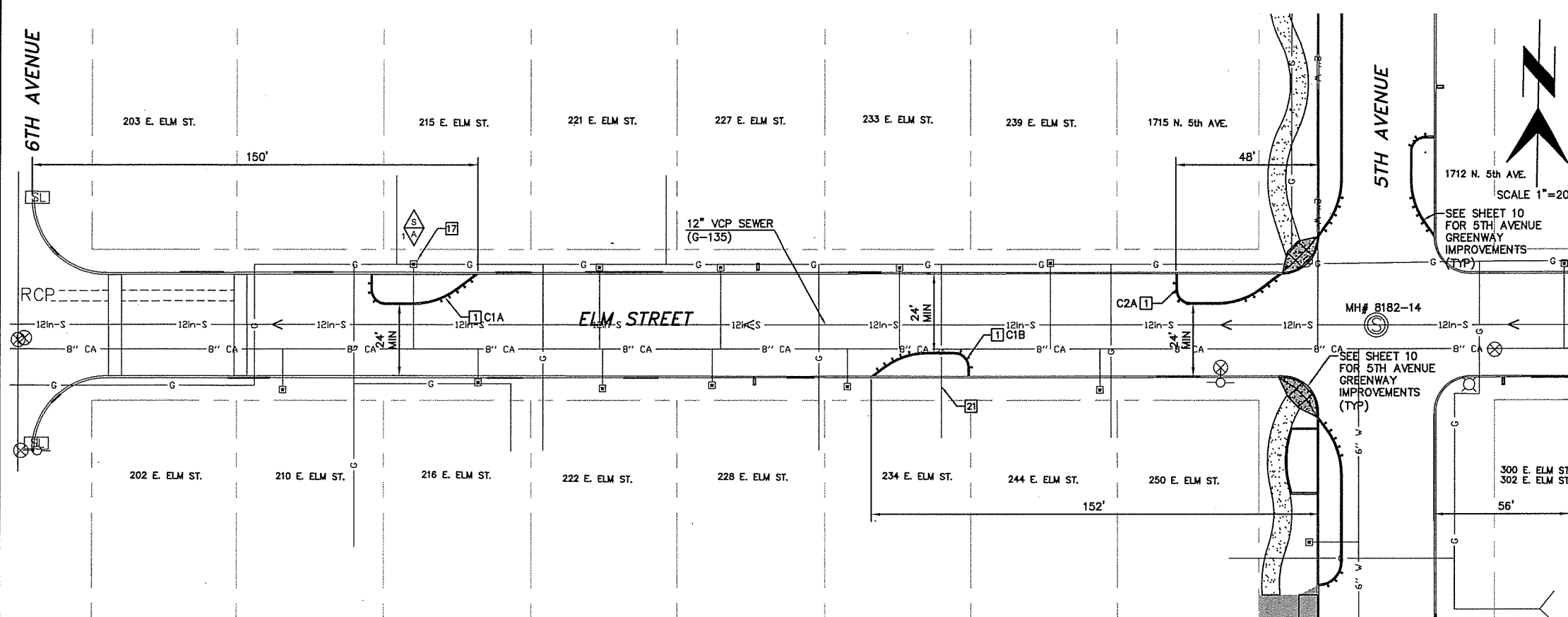

U:\TUC\Projects\0001\4000 Northwest Neighborhood Grant\CD\01\134000PP01.dwg Jul 15, 2010 rls:sls  
PLOT: 134000PP01 134000PP01 134000PP01 134000PP01

800-782-5348  
ARIZONA BLUE STONE COVER  
TOLL FREE

SEE PREVIOUS SHEET

SEE ABOVE RIGHT

SEE BELOW LEFT

SEE NEXT SHEET

CONSTRUCTION NOTES:

1. INSTALL NEW CHICANE PER DETAILS C1, C2 OR C3. INSTALL CHICANE TYPE AS INDICATED ON PLAN.
2. INSTALL ASPHALTIC CONCRETE RESIDENTIAL DRIVEWAY ACCESS PER DETAIL G1. INSTALL DRIVEWAY FROM BACK OF EXISTING CURB TO EXISTING PROPERTY LINE.
3. INSTALL GREENWAY WATER HARVESTING POCKET PER DETAIL G5.
4. INSTALL 6' WIDE CURB RAMP PER COT/PC STD. DTL. 207 AND GREENWAY STREET INTERSECTION CONNECTION TYPE 1 PER DETAIL G3.
5. INSTALL 5' WIDE CURB RAMP PER COT/PC STD. DTL. 207 AND GREENWAY STREET INTERSECTION CONNECTION TYPE 2 PER DETAIL G4.
6. INSTALL 6' WIDE PEDESTRIAN RAMP ACCESS PER DETAIL G2.
7. INSTALL 6' MEANDERING STABILIZED DECOMPOSED GRANITE PATH (3" DEPTH) PER DETAIL G6. CENTERLINE RADIUS BETWEEN 25' AND 50'.
8. INSTALL CURB ACCESS RAMP PER ADOT STD. DTL. C-05.30 TYPE E.
9. INSTALL 6' PAVER PATH WITH 6"x12" CONCRETE HEADER PER COT/PC STD. DTL. 201 AND TYPICAL SECTION ON THESE PLANS. CENTERLINE RADIUS SHALL BE APPROX. 25'.
10. INSTALL 8' WIDE GREENWAY PER TYPICAL SECTION A & B. 6" VERTICAL CURB AND SAWCUT LENGTHS PER PLAN (EXCLUDES 2' CURB END TERMINALS).
11. INSTALL 6" THICK CONCRETE SLAB ON GRADE. CONSTRUCT WITH JOINTS AT 10' INTERVALS FILLED WITH BITUMINOUS JOINT FILLER. REMOVE EXISTING ASPHALT CONCRETE, SCARIFY EXISTING AND RECOMPACT TO 95% PROCTOR DENSITY.
12. INSTALL 6"x12" CONCRETE HEADER AT TERMINATION OF 6' PAVER PATH.
13. PROTECT EXISTING FIRE HYDRANT IN PLACE.
14. ADJUST EXISTING WATER VALVE BOX AND COVER TO GRADE PER COT/PC STD. DTL. W-300.
15. RELOCATE EXISTING MAIL RECEPTACLE AND POST/SUPPORT PER COT/PC STD. DTL. 102 TO PROVIDE DRIVE-UP ACCESS BY U.S.P.S. NEW LOCATIONS ON 5TH AVENUE AND ELM STREET
16. INSTALL OCOTILLO FENCING WALL TREATMENT 1' OFFSET FROM EXISTING WALL.
17. PROTECT EXISTING WATER VALVE/METER IN PLACE
18. CONSTRUCT CURB INLET PER DETAIL G5.
19. PROTECT EXISTING STREET LIGHT IN PLACE.
20. ADJUST EXISTING SEWER MANHOLE TO GRADE PER COT/PC STD. DTL. WWM-304.
21. CONTRACTOR TO COORDINATE WITH SOUTHWEST GAS FOR RELOCATION OF GAS LINE.

- NOTES:
1. ALL PROPOSED FACE OF CURB SHALL REMAIN 1 FOOT MINIMUM FROM EXISTING WATER LINES.
  2. REFER TO DETAILS C1, C2, C3, G1, G2, G3, AND G4 FOR TYPICAL HEADER, SAWCUT, AND FULL DEPTH REPLACEMENT QUANTITIES.

SERVICE WORK			
CODE	ADDRESS	PIPE SIZE & QUANT. (IN FEET ±)	
	METER # & SIZE	3"	1" 1 1/2" 2"
4 S A	#27652134, 8"	20'	
5 S A	#07009035, 8"	12'	
TOTAL QUANTITIES OF CU PIPE FOR SERVICE WORK ONLY		32'	

CONSTRUCTION PLAN SHEET

DEPARTMENT OF TRANSPORTATION/ENGINEERING DIVISION  
NORTHWEST NEIGHBORHOOD PIMA COUNTY  
NEIGHBORHOOD REINVESTMENT GRANT PROJECT

8  
OF  
11

CITY OF TUCSON  
DRAWN BY: S. Schenberger 7/2010  
DESIGN BY: R. Sells 7/2010  
CHECKED BY: R. Sells 7/2010  
REF. SCALE: 1"=20'  
PLAN NO. U-2010-001

**Kimley-Horn and Associates, Inc.**  
© 2010 KIMLEY-HORN AND ASSOCIATES, INC.  
2210 East Fort Lowell Road, Suite 200  
Tucson, Arizona 85719 (520) 615-9191

NO.	DATE	REVISION	BY	CHKD.	APPR.
-----	------	----------	----	-------	-------

K:\TUC\_Northwest\080134003\_Northwest\_Neighborhood\_Grants\CD\0134003plan02.dwg Jul 15, 2010 rls:mls  
PLOT: 134003-PRB 134003-PRB 134003-PRB 134003-PRB 134003-PRB 134003-PRB

800-782-5348  
ARIZONA BLUE PRINT CENTER  
TOLL FREE





LEE STREET

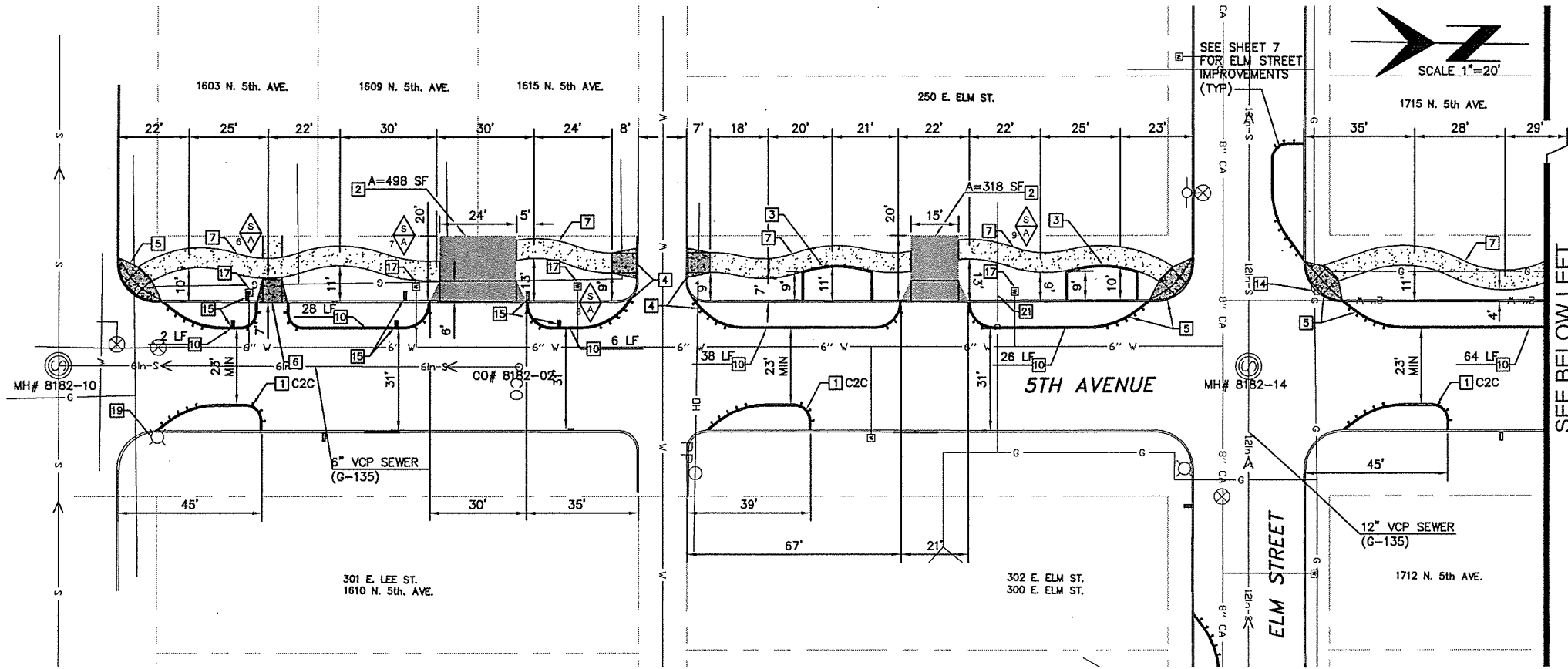

CONSTRUCTION NOTES:

1. INSTALL NEW CHICANE PER DETAILS C1, C2 OR C3. INSTALL CHICANE TYPE AS INDICATED ON PLAN.
  2. INSTALL ASPHALTIC CONCRETE RESIDENTIAL DRIVEWAY ACCESS PER DETAIL G1. INSTALL DRIVEWAY FROM BACK OF EXISTING CURB TO EXISTING PROPERTY LINE.
  3. INSTALL GREENWAY WATER HARVESTING POCKET PER DETAIL G5.
  4. INSTALL 6' WIDE CURB RAMP PER COT/PC STD. DTL. 207 AND GREENWAY STREET INTERSECTION CONNECTION TYPE 1 PER DETAIL G3.
  5. INSTALL 5' WIDE CURB RAMP PER COT/PC STD. DTL. 207 AND GREENWAY STREET INTERSECTION CONNECTION TYPE 2 PER DETAIL G4.
  6. INSTALL 6' WIDE PEDESTRIAN RAMP ACCESS PER DETAIL G2.
  7. INSTALL 6' MEANDERING STABILIZED DECOMPOSED GRANITE PATH (3" DEPTH) PER DETAIL G6. CENTERLINE RADIUS BETWEEN 25' AND 50'.
  8. INSTALL CURB ACCESS RAMP PER ADOT STD. DTL. C-05.30 TYPE E.
  9. INSTALL 6' PAVER PATH WITH 6"x12" CONCRETE HEADER PER COT/PC STD. DTL. 201 AND TYPICAL SECTION ON THESE PLANS. CENTERLINE RADIUS SHALL BE APPROX. 25'.
  10. INSTALL 8' WIDE GREENWAY PER TYPICAL SECTION A & B. 6" VERTICAL CURB AND SAWCUT LENGTHS PER PLAN (EXCLUDES 2' CURB END TERMINALS).
  11. INSTALL 6" THICK CONCRETE SLAB ON GRADE. CONSTRUCT WITH JOINTS AT 10' INTERVALS FILLED WITH BITUMINOUS JOINT FILLER. REMOVE EXISTING ASPHALT CONCRETE, SCARIFY EXISTING AND RECOMPACT TO 95% PROCTOR DENSITY.
  12. INSTALL 6"x12" CONCRETE HEADER AT TERMINATION OF 6' PAVER PATH.
  13. PROTECT EXISTING FIRE HYDRANT IN PLACE.
  14. ADJUST EXISTING WATER VALVE BOX AND COVER TO GRADE PER COT/PC STD. DTL. W-300.
  15. RELOCATE EXISTING MAIL RECEPTACLE AND POST/SUPPORT PER COT/PC STD. DTL. 102 TO PROVIDE DRIVE-UP ACCESS BY U.S.P.S. NEW LOCATIONS ON 5TH AVENUE AND ELM STREET.
  16. INSTALL OCOTILLO FENCING WALL TREATMENT 1' OFFSET FROM EXISTING WALL.
  17. PROTECT EXISTING WATER VALVE/METER IN PLACE.
  18. CONSTRUCT CURB INLET PER DETAIL G5.
  19. PROTECT EXISTING STREET LIGHT IN PLACE.
  20. ADJUST EXISTING SEWER MANHOLE TO GRADE PER COT/PC STD. DTL. WWM-304.
  21. CONTRACTOR TO COORDINATE WITH SOUTHWEST GAS FOR RELOCATION OF GAS LINE.
- NOTES:

1. ALL PROPOSED FACE OF CURB SHALL REMAIN 1 FOOT MINIMUM FROM EXISTING WATER LINES.
2. REFER TO DETAILS C1, C2, C3, G1, G2, G3, AND G4 FOR TYPICAL HEADER, SAWCUT, AND FULL DEPTH REPLACEMENT QUANTITIES.

SERVICE WORK

LINE	CODE	ADDRESS	PIPE SIZE & QUANT. (IN FEET ±)			
			3"	1"	1 1/2"	2"
6	S	METER # & SIZE				
	A	#07007504, 8"	15'			
7	S	#07007506, 8"	15'			
	A	#06430903, 8"	15'			
8	S	#07007633, 8"	15'			
	A					
9	S					
	A					
TOTAL QUANTITIES OF CU PIPE FOR SERVICE WORK ONLY			60'			

CONSTRUCTION PLAN SHEET

DEPARTMENT OF TRANSPORTATION/ENGINEERING DIVISION  
NORTHWEST NEIGHBORHOOD PIMA COUNTY  
NEIGHBORHOOD REINVESTMENT GRANT PROJECT



DRWN. BY S. Shellenberger 7/2010  
DSCH. BY R. Solt 7/2010  
CHKD. BY R. Solt 7/2010  
REF. SCALE: 1"=20'  
PLAN NO. U-2010-001

Kimley-Horn  
and Associates, Inc.  
© 2010 KIMLEY-HORN AND ASSOCIATES, INC.  
2210 East Fort Lowell Road, Suite 200  
Tucson, Arizona 85719 (520) 615-9191

NO. DATE REVISION BY CHKD. APPR.

U:\Projects\2010\2010 NW Neighborhood Grant\Drawings\2010 NW Neighborhood Grant\2010 NW Neighborhood Grant.dwg 15 JUL 2010 14:45:00

800-782-5348  
ARIZONA BLUE STONE CENTER  
TOL FREE

SEE PREVIOUS SHEET

SEE ABOVE RIGHT

## CONSTRUCTION NOTES:

1. INSTALL NEW CHICANE PER DETAILS C1, C2 OR C3. INSTALL CHICANE TYPE AS INDICATED ON PLAN.
2. INSTALL ASPHALTIC CONCRETE RESIDENTIAL DRIVEWAY ACCESS PER DETAIL G1. INSTALL DRIVEWAY FROM BACK OF EXISTING CURB TO EXISTING PROPERTY LINE.
3. INSTALL GREENWAY WATER HARVESTING POCKET PER DETAIL G5.
4. INSTALL 6' WIDE CURB RAMP PER COT/PC STD. DTL. 207 AND GREENWAY STREET INTERSECTION CONNECTION TYPE 1 PER DETAIL G3.
5. INSTALL 5' WIDE CURB RAMP PER COT/PC STD. DTL. 207 AND GREENWAY STREET INTERSECTION CONNECTION TYPE 2 PER DETAIL G4.
6. INSTALL 6' WIDE PEDESTRIAN RAMP ACCESS PER DETAIL G2.
7. INSTALL 6' MEANDERING STABILIZED DECOMPOSED GRANITE PATH (3" DEPTH) PER DETAIL G6. CENTERLINE RADIUS BETWEEN 25' AND 50'.
8. INSTALL CURB ACCESS RAMP PER ADOT STD. DTL. C-05.30 TYPE E.
9. INSTALL 6' PAVER PATH WITH 6"x12" CONCRETE HEADER PER COT/PC STD. DTL. 201 AND TYPICAL SECTION ON THESE PLANS. CENTERLINE RADIUS SHALL BE APPROX. 25'.
10. INSTALL 8' WIDE GREENWAY PER TYPICAL SECTION A & B. 6" VERTICAL CURB AND SAWCUT LENGTHS PER PLAN (EXCLUDES 2' CURB END TERMINALS).
11. INSTALL 6" THICK CONCRETE SLAB ON GRADE. CONSTRUCT WITH JOINTS AT 10' INTERVALS FILLED WITH BITUMINOUS JOINT FILLER. REMOVE EXISTING ASPHALT CONCRETE, SCARIFY EXISTING AND RECOMPACT TO 95% PROCTOR DENSITY.
12. INSTALL 6"x12" CONCRETE HEADER AT TERMINATION OF 6' PAVER PATH.
13. PROTECT EXISTING FIRE HYDRANT IN PLACE.
14. ADJUST EXISTING WATER VALVE BOX AND COVER TO GRADE PER COT/PC STD. DTL. W-300.
15. RELOCATE EXISTING MAIL RECEPTACLE AND POST/SUPPORT PER COT/PC STD. DTL. 102 TO PROVIDE DRIVE-UP ACCESS BY U.S.P.S. NEW LOCATIONS ON 5TH AVENUE AND ELM STREET.
16. INSTALL OCOTILLO FENCING WALL TREATMENT 1' OFFSET FROM EXISTING WALL.
17. PROTECT EXISTING WATER VALVE/METER IN PLACE.
18. CONSTRUCT CURB INLET PER DETAIL G5.
19. PROTECT EXISTING STREET LIGHT IN PLACE.
20. ADJUST EXISTING SEWER MANHOLE TO GRADE PER COT/PC STD. DTL. WWM-304.
21. CONTRACTOR TO COORDINATE WITH SOUTHWEST GAS FOR RELOCATION OF GAS LINE.

- NOTES:
1. ALL PROPOSED FACE OF CURB SHALL REMAIN 1 FOOT MINIMUM FROM EXISTING WATER LINES.
  2. REFER TO DETAILS C1, C2, C3, G1, G2, G3, AND G4 FOR TYPICAL HEADER, SAWCUT, AND FULL DEPTH REPLACEMENT QUANTITIES.

## CONSTRUCTION PLAN SHEET

DEPARTMENT OF TRANSPORTATION/ENGINEERING DIVISION  
NORTHWEST NEIGHBORHOOD PIMA COUNTY  
NEIGHBORHOOD REINVESTMENT GRANT PROJECT

11  
OF  
11



DRWN. BY S. Shellenberger 7/2010  
DSGN. BY R. Sells 7/2010  
CHKD. BY R. Sells 7/2010  
REF. \_\_\_\_\_ SCALE: 1"=20'  
PLAN NO. U-2010-001

**Kimley-Horn  
and Associates, Inc.**

© 2010 KIMLEY-HORN AND ASSOCIATES, INC.  
2210 East Fort Lowell Road, Suite 200  
Tucson, Arizona 85719 (520) 615-9191

NO.	DATE	REVISION	BY	CHKD.	APPR.

K:\TUC\Resident\0801\0801\_Northwest\_Neighborhood\_Grant\CD\001\134000PRD.dwg Jul 15, 2010 rls:ash  
262735 134000PRD 134000PRD 134000PRD 134000PRD 134000PRD

TWO WEEKS DATE BEFORE YOU DO  
CALL FOR THE BLUE STAMP  
**800-782-5348**  
ARIZONA BLUE STAMP CENTER  
YOUR PRICE

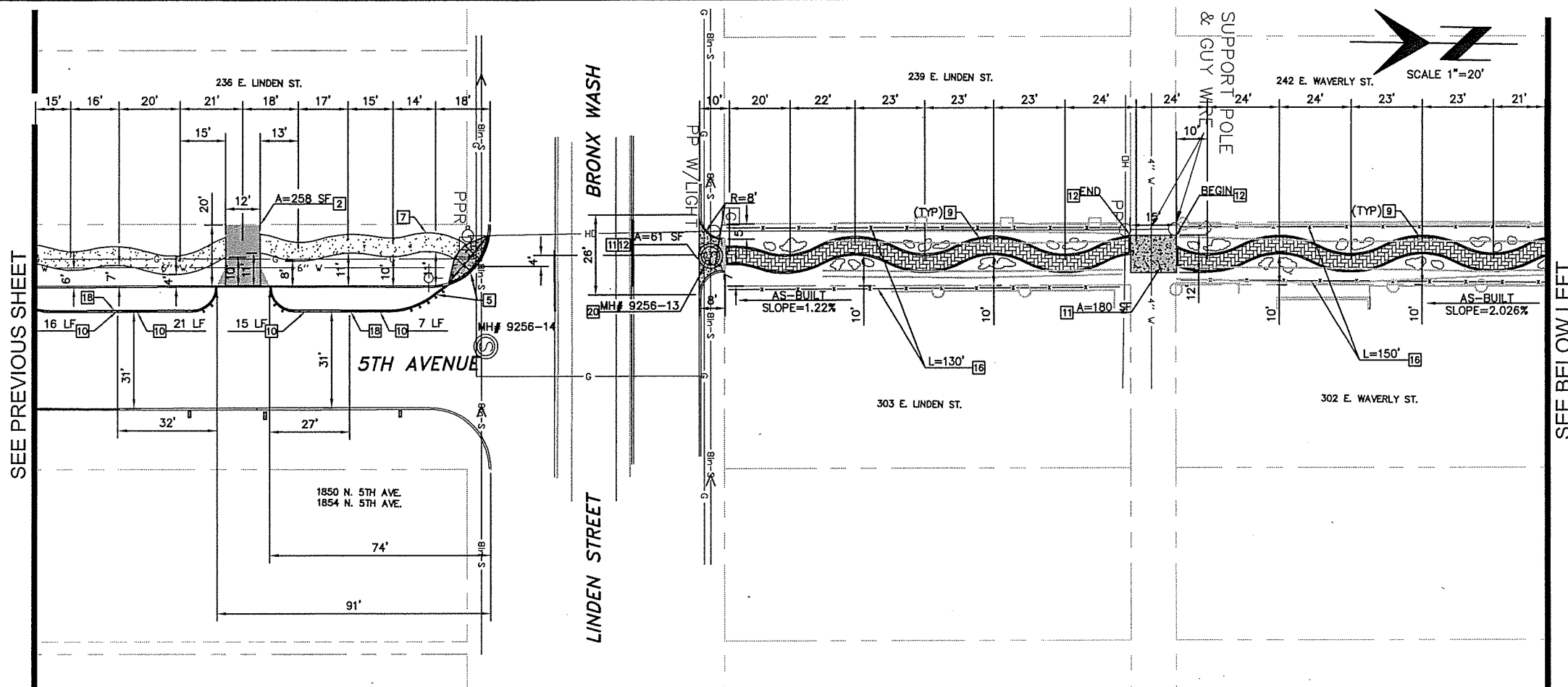

SCALE 1"=20'

SCALE 1"=10'

